

**Flood Control Project Maintenance
Levee Inspections**

Maintenance Issue Types Only, Levee Inspection Report By Mile - Fall 2021

Reclamation District No. 0003 Grand Island

Waterway	Bank	Unit Miles	Inspection Start/End	Inspector
Unit No. 01 Left Bank Steamboat Slough	Left	10.95	10/06/2021 10/06/2021	David Julian

LM Start	0.00	Rating **	A	Issue No.	102
LM End	0.00	Issue Type +	Ma	Location *	N/A
Category	Earthen Levee			GPS Latitude/Longitude	
				Start	End
Item	Operations & Maintenance Manuals				
DWR ID	DWR_RD0003_01_s_2019_102				
Comment Code					
Inspector Comment					
LMA has a copy of the O & M manual on file at district office.					

No Photos

LM Start	0.00	Rating **	A	Issue No.	103
LM End	0.00	Issue Type +	Ma	Location *	N/A
Category	Earthen Levee			GPS Latitude/Longitude	
				Start	End
Item	Emergency Supplies & Equipment				
DWR ID	DWR_RD0003_01_s_2013_103				
Comment Code					
Inspector Comment					
District keeps supplies at pumphouse on Steamboat Slough and at Ryde. District says it has adequate supplies.					

No Photos

LM Start	0.00	Rating **	A	Issue No.	104
LM End	0.00	Issue Type +	Ma	Location *	N/A
Category	Earthen Levee			GPS Latitude/Longitude	
				Start	End
Item	Flood Preparedness & Training				
DWR ID	DWR_RD0003_01_s_2013_104				
Comment Code					
Inspector Comment					
District personnel have done flood fight training course in the last two years.					

No Photos

* Location LS : Land Side N/A : Not Applicable WS : Water Side CR : Crown	** Rating A : Acceptable M : Minimally Acceptable U : Unacceptable	N : Not Inspected/Rated C : Corrected A/W : Acceptable but Monitor & Maintain	+ Issue Type Ma : Maintenance Deficiency Ob : Design & System Obsolescence En : Enforcement
--	--	---	---

**Flood Control Project Maintenance
Levee Inspections**

Maintenance Issue Types Only, Levee Inspection Report By Mile - Fall 2021

Reclamation District No. 0003 Grand Island

Waterway	Bank	Unit Miles	Inspection Start/End	Inspector
Unit No. 01 Left Bank Steamboat Slough	Left	10.95	10/06/2021 10/06/2021	David Julian

LM Start	0.13	Rating **	M	Issue No.	2
LM End	0.13	Issue Type +	Ma	Location *	WS
Category	Earthen Levee			GPS Latitude/Longitude	
				Start	End
Item	Erosion / Bank Caving			38.303303 °	38.303303 °
				-121.576538 °	-121.576538 °
DWR ID	DWR_RD0003_01_f_2013_2				
Comment Code					
E2 : Schedule repair of erosion site prior to the next inspection.					
Inspector Comment					
A hole (8ft x 2.5ft x 5ft) is next to a large tree on waterward shoulder.					

Photo 1 of 1 : FA_2021_RD0003_24_2_20210830_00001.jpg



View of hole on the waterside shoulder due to fallen tree (Fall 2020).

LM Start	0.14	Rating **	M	Issue No.	64
LM End	0.14	Issue Type +	Ma	Location *	WS
Category	Earthen Levee			GPS Latitude/Longitude	
				Start	End
Item	Encroachments			38.303210 °	38.303210 °
				-121.576642 °	-121.576642 °
DWR ID	DWR_RD0003_01_f_2019_64				
Comment Code					
TR : Tree or limb					
Inspector Comment					

Photo 1 of 1 : FA_2021_RD0003_24_64_20211006_00289.jpg



View of tree branches on the waterside slope (Fall 2021).

LM Start	0.16	Rating **	M	Issue No.	131
LM End	0.16	Issue Type +	Ma	Location *	LS
Category	Earthen Levee			GPS Latitude/Longitude	
				Start	End
Item	Slope Stability			38.303111 °	38.303111 °
				-121.576842 °	-121.576842 °
DWR ID	DWR_RD0003_01_f_2021_131				
Comment Code					
S3 : Repair the levee slope damaged by vehicle traffic and prevent access where possible.					
Inspector Comment					
Vehicle tracks dug out hole on the landside hinge.					

Photo 1 of 1 : FA_2021_RD0003_24_131_20211006_00290.jpg



View looking downstream at vehicle tracks in the landside hinge (Fall 2021).

* Location		** Rating		+ Issue Type	
LS : Land Side	N/A : Not Applicable	A : Acceptable	N : Not Inspected/Rated	Ma : Maintenance Deficiency	
WS : Water Side		M : Minimally Acceptable	C : Corrected	Ob : Design & System Obsolescence	
CR : Crown		U : Unacceptable	A/W : Acceptable but Monitor & Maintain	En : Enforcement	

**Flood Control Project Maintenance
Levee Inspections**

Maintenance Issue Types Only, Levee Inspection Report By Mile - Fall 2021

Reclamation District No. 0003 Grand Island

Waterway	Bank	Unit Miles	Inspection Start/End	Inspector
Unit No. 01 Left Bank Steamboat Slough	Left	10.95	10/06/2021 10/06/2021	David Julian

LM Start	0.18	Rating **	A/W	Issue No.	49
LM End	0.24	Issue Type +	Ma	Location *	WS
Category	Supplemental			GPS Latitude/Longitude	
				Start	End
Item	2018 USACE Erosion Survey			38.303035 °	38.302544 °
				-121.577357 °	-121.578241 °
DWR ID					

Comment Code

Inspector Comment

2018 Site ID: STM 26.0 L
 Status: Critical
 2018 Field Notes: New erosion throughout site.
 Site History: 1997 - Mass failure of berm slope and wave wash erosion. Large trees on top of berm, some failed trees. New area of low rock to on the upstream end. 2000 - Some minor erosion near the downstream end. 2005 - One new small tree has fallen. 2009 - Minimal new erosion. 2010 - Minor new erosion. 2013 - Observed new animal holes and vertical sections at middle of site. 2015 - Minor new erosion. 2017 - Upgraded to CRITICAL. Significant bank failure on upstream end.

LM Start	0.18	Rating **	A/W	Issue No.	49 (cont)
LM End	0.24	Issue Type +	Ma	Location *	WS

DWR ID	
--------	--

Photo 1 of 2 : FA_2021_RD0003_24_49_20211218_70.jpg



USACE 2018 Erosion Photo #1

Photo 2 of 2 : FA_2021_RD0003_24_49_20211218_71.jpg



USACE 2018 Erosion Photo #2

* Location LS : Land Side N/A : Not Applicable WS : Water Side CR : Crown		** Rating A : Acceptable N : Not Inspected/Rated M : Minimally Acceptable C : Corrected U : Unacceptable A/W : Acceptable but Monitor & Maintain		+ Issue Type Ma : Maintenance Deficiency Ob : Design & System Obsolescence En : Enforcement
--	--	---	--	---

Reclamation District No. 0003 Grand Island

38.30282, -121.5774, -36.0m, 290°
Jul 26, 2017 12:05:40 PM

Page 4 of 23

**Flood Control Project Maintenance
Levee Inspections**

Maintenance Issue Types Only, Levee Inspection Report By Mile - Fall 2021

Reclamation District No. 0003 Grand Island

Waterway	Bank	Unit Miles	Inspection Start/End	Inspector
Unit No. 01 Left Bank Steamboat Slough	Left	10.95	10/06/2021 10/06/2021	David Julian

LM Start	0.18	Rating **	A/W	Issue No.	52 (cont)
LM End	0.21	Issue Type +	Ma	Location *	WS
Category	Supplemental			GPS Latitude/Longitude	
				Start	End
Item	2017 Storm Damage			38.302981 °	38.302778 °
				-121.577336 °	-121.577683 °
DWR ID	LMA-100				

Photo 3 of 3 : LEVAL_FA_2021_274_2395.jpg

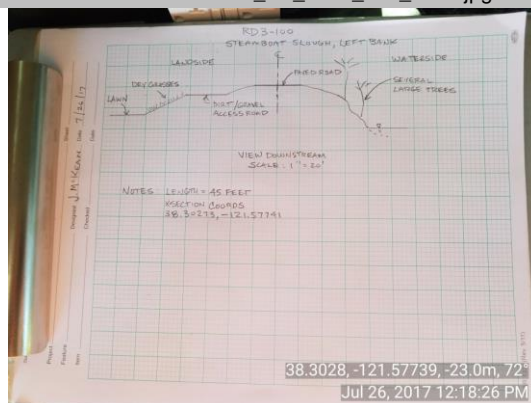

LM Start	0.29	Rating **	M	Issue No.	133
LM End	0.45	Issue Type +	Ma	Location *	LS
Category	Earthen Levee			GPS Latitude/Longitude	
				Start	End
Item	Vegetation			38.301842 °	38.299777 °
				-121.578849 °	-121.579909 °
DWR ID	DWR_RD0003_01_f_2021_133				
Comment Code					
V1 : Control annual grass and weeds on the levee slopes and easements.					
Inspector Comment					

No Photos

LM Start	0.55	Rating **	M	Issue No.	134
LM End	0.60	Issue Type +	Ma	Location *	LS
Category	Earthen Levee			GPS Latitude/Longitude	
				Start	End
Item	Vegetation			38.298469 °	38.297694 °
				-121.580750 °	-121.580962 °
DWR ID	DWR_RD0003_01_f_2021_134				
Comment Code					
V1 : Control annual grass and weeds on the levee slopes and easements.					
Inspector Comment					

No Photos

* Location LS : Land Side N/A : Not Applicable WS : Water Side CR : Crown		** Rating A : Acceptable M : Minimally Acceptable U : Unacceptable N : Not Inspected/Rated C : Corrected A/W : Acceptable but Monitor & Maintain		+ Issue Type Ma : Maintenance Deficiency Ob : Design & System Obsolescence En : Enforcement	
--	--	---	--	---	--

**Flood Control Project Maintenance
Levee Inspections**

Maintenance Issue Types Only, Levee Inspection Report By Mile - Fall 2021

Reclamation District No. 0003 Grand Island

Waterway	Bank	Unit Miles	Inspection Start/End	Inspector
Unit No. 01 Left Bank Steamboat Slough	Left	10.95	10/06/2021 10/06/2021	David Julian

LM Start	0.91	Rating **	A/W	Issue No.	147
LM End	0.91	Issue Type +	Ma	Location *	LS
Category	Earthen Levee			GPS Latitude/Longitude	
				Start	End
Item	Animal Control			38.293463 °	38.293463 °
				-121.582275 °	-121.582275 °
DWR ID	DWR_RD0003_01_f_2020_147				
Comment Code					
A1 : Exterminate rodents and backfill and compact or grout burrows.					
Inspector Comment					
No new rodent holes. Monitor.					

Photo 1 of 1 : FA_2021_RD0003_24_147_20210830_00058.jpg



View looking downstream at multiple fresh rodent holes in the landside slope (Fall 2020).

LM Start	0.91	Rating **	A/W	Issue No.	53
LM End	0.97	Issue Type +	Ma	Location *	WS
Category	Supplemental			GPS Latitude/Longitude	
				Start	End
Item	2017 Storm Damage			38.293381 °	38.292617 °
				-121.582450 °	-121.582675 °
DWR ID	LMA-101				
Comment Code					
Inspector Comment					
Planned For Repair.					
Levee Evaluation Comments					
Description:District station 48+20 to 51+06, Sec. 07, T. 5 N. R. 4 E., M.D.M. An erosion site exists along approximately 286 linear feet of the waterside slope of Steamboat Slough (Unit 1). The erosion begins approximately 1/2 of the way down the slope from the crown to the waterside toe. Erosion is undercutting existing trees.					
Site ID No:275					
Site Designation:LMA-101					
Repair Type: Erosion					
Rating:Serious					
Field Date:7/26/2017					
Notes:					

Photo 1 of 3 : LEVAL_FA_2021_275_2396.jpg

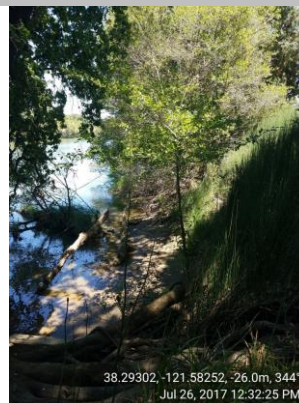

* Location LS : Land Side N/A : Not Applicable WS : Water Side CR : Crown		** Rating A : Acceptable M : Minimally Acceptable U : Unacceptable N : Not Inspected/Rated C : Corrected A/W : Acceptable but Monitor & Maintain		+ Issue Type Ma : Maintenance Deficiency Ob : Design & System Obsolescence En : Enforcement	
--	--	---	--	---	--

**Flood Control Project Maintenance
Levee Inspections**

Maintenance Issue Types Only, Levee Inspection Report By Mile - Fall 2021

Reclamation District No. 0003 Grand Island

Waterway	Bank	Unit Miles	Inspection Start/End	Inspector
Unit No. 01 Left Bank Steamboat Slough	Left	10.95	10/06/2021 10/06/2021	David Julian

LM Start	0.91	Rating **	A/W	Issue No.	53 (cont)
LM End	0.97	Issue Type +	Ma	Location *	WS
Category	Supplemental			GPS Latitude/Longitude	
				Start	End
Item	2017 Storm Damage			38.293381 °	38.292617 °
				-121.582450 °	-121.582675 °
DWR ID	LMA-101				

Photo 2 of 3 : LEVAL_FA_2021_275_2398.jpg



LM Start	0.91	Rating **	A/W	Issue No.	53 (cont)
LM End	0.97	Issue Type +	Ma	Location *	WS

Photo 3 of 3 : LEVAL_FA_2021_275_2399.jpg



* Location LS : Land Side N/A : Not Applicable WS : Water Side CR : Crown		** Rating A : Acceptable N : Not Inspected/Rated M : Minimally Acceptable C : Corrected U : Unacceptable A/W : Acceptable but Monitor & Maintain		+ Issue Type Ma : Maintenance Deficiency Ob : Design & System Obsolescence En : Enforcement
--	--	---	--	---

**Flood Control Project Maintenance
Levee Inspections**

Maintenance Issue Types Only, Levee Inspection Report By Mile - Fall 2021

Reclamation District No. 0003 Grand Island

Waterway	Bank	Unit Miles	Inspection Start/End	Inspector
Unit No. 01 Left Bank Steamboat Slough	Left	10.95	10/06/2021 10/06/2021	David Julian

LM Start	1.09	Rating **	U	Issue No.	60
LM End	1.10	Issue Type +	Ma	Location *	WS
Category	Earthen Levee			GPS Latitude/Longitude	
				Start	End
Item	Erosion / Bank Caving			38.290819 °	38.290706 °
				-121.582942 °	-121.582939 °
DWR ID	LMA-102				
Comment Code					
E2 : Schedule repair of erosion site prior to the next inspection.					
Inspector Comment					
<p>This was a 2017 Storm Damage site.</p> <p>An erosion site exists along approximately 41 linear feet of the water side slope.</p> <p>Site ID No:276</p> <p>Site Designation:LMA-102</p> <p>6/18/2020 Boat Inspection:</p> <p>Significant erosion into waterside prism directly upstream of tree that is leaning into water. That leaning tree is creating an eddy that is causing the erosion. There is also some less significant erosion into the waterside toe upstream of the significant erosion site.</p>					

LM Start	1.09	Rating **	U	Issue No.	60 (cont)
LM End	1.10	Issue Type +	Ma	Location *	WS

Photo 1 of 2 : FA_2021_RD0003_24_60_20210830_00025.jpg



View from the channel of leaning tree and erosion into waterside prism (Summer 2020).

Photo 2 of 2 : FA_2021_RD0003_24_60_20210830_00026.jpg



View from the channel of erosion into waterside toe upstream deep erosion (Summer 2020).

* Location LS : Land Side N/A : Not Applicable WS : Water Side CR : Crown		** Rating A : Acceptable N : Not Inspected/Rated M : Minimally Acceptable C : Corrected U : Unacceptable A/W : Acceptable but Monitor & Maintain		+ Issue Type Ma : Maintenance Deficiency Ob : Design & System Obsolescence En : Enforcement
--	--	---	--	---

**Flood Control Project Maintenance
Levee Inspections**

Maintenance Issue Types Only, Levee Inspection Report By Mile - Fall 2021

Reclamation District No. 0003 Grand Island

Waterway	Bank	Unit Miles	Inspection Start/End	Inspector
Unit No. 01 Left Bank Steamboat Slough	Left	10.95	10/06/2021 10/06/2021	David Julian

LM Start	1.16	Rating **	U	Issue No.	135	
LM End	1.16	Issue Type +	Ma	Location *	LS	
Category	Earthen Levee			GPS Latitude/Longitude		
				Start		End
Item	Vegetation			38.289813 °	38.289813 °	
				-121.582793 °	-121.582793 °	
DWR ID	DWR_RD0003_01_f_2021_135					
Comment Code						
V2 : Remove the wild growth other than native grasses from the levee slopes.						
Inspector Comment						
New oak trees beginning to establish on landside toe.						

Photo 1 of 1 : FA_2021_RD0003_24_135_20211006_00291.jpg



View looking downslope at new oak trees on the landside toe (Fall 2021).

LM Start	1.29	Rating **	U	Issue No.	148
LM End	1.29	Issue Type +	Ma	Location *	LS
Category	Earthen Levee			GPS Latitude/Longitude	
				Start	End
Item	Trim / Thin Trees			38.287850 °	38.287850 °
				-121.582833 °	-121.582833 °
DWR ID	DWR_RD0003_01_f_2020_148				
Comment Code					
T2 : Thin trees to allow visibility of the ground and room to flood fight.					
Inspector Comment					

Photo 1 of 1 : FA_2021_RD0003_24_148_20210830_00059.jpg



View of trees partially blocking view down the landside slope (Fall 2020).

LM Start	1.52	Rating **	M	Issue No.	149
LM End	1.52	Issue Type +	Ma	Location *	LS
Category	Earthen Levee			GPS Latitude/Longitude	
				Start	End
Item	Animal Control			38.285497 °	38.285497 °
				-121.585362 °	-121.585362 °
DWR ID	DWR_RD0003_01_f_2020_149				
Comment Code					
A1 : Exterminate rodents and backfill and compact or grout burrows.					
Inspector Comment					
A couple fresh rodent holes.					

Photo 1 of 1 : FA_2021_RD0003_24_149_20210830_00060.jpg



View of a fresh rodent hole in the landside slope (Fall 2020).

* Location LS : Land Side N/A : Not Applicable WS : Water Side CR : Crown		** Rating A : Acceptable M : Minimally Acceptable U : Unacceptable		N : Not Inspected/Rated C : Corrected A/W : Acceptable but Monitor & Maintain		+ Issue Type Ma : Maintenance Deficiency Ob : Design & System Obsolescence En : Enforcement	
--	--	--	--	---	--	---	--

**Flood Control Project Maintenance
Levee Inspections**

Maintenance Issue Types Only, Levee Inspection Report By Mile - Fall 2021

Reclamation District No. 0003 Grand Island

Waterway	Bank	Unit Miles	Inspection Start/End	Inspector
Unit No. 01 Left Bank Steamboat Slough	Left	10.95	10/06/2021 10/06/2021	David Julian

LM Start	1.82	Rating **	M	Issue No.	138
LM End	1.94	Issue Type +	Ma	Location *	LS
Category	Earthen Levee			GPS Latitude/Longitude	
				Start	End
Item	Vegetation			38.281935 °	38.280228 °
				-121.588425 °	-121.588425 °
DWR ID	DWR_RD0003_01_f_2021_138				
Comment Code					
V1 : Control annual grass and weeds on the levee slopes and easements.					
Inspector Comment					

No Photos

LM Start	2.52	Rating **	M	Issue No.	139
LM End	2.57	Issue Type +	Ma	Location *	LS
Category	Earthen Levee			GPS Latitude/Longitude	
				Start	End
Item	Vegetation			38.272974 °	38.272322 °
				-121.587635 °	-121.588036 °
DWR ID	DWR_RD0003_01_f_2021_139				
Comment Code					
V2 : Remove the wild growth other than native grasses from the levee slopes.					
Inspector Comment					

No Photos

LM Start	2.93	Rating **	M	Issue No.	141
LM End	3.00	Issue Type +	Ma	Location *	LS
Category	Earthen Levee			GPS Latitude/Longitude	
				Start	End
Item	Vegetation			38.267463 °	38.266448 °
				-121.587339 °	-121.587119 °
DWR ID	DWR_RD0003_01_f_2021_141				
Comment Code					
V1 : Control annual grass and weeds on the levee slopes and easements.					
Inspector Comment					

No Photos

* Location LS : Land Side N/A : Not Applicable WS : Water Side CR : Crown		** Rating A : Acceptable N : Not Inspected/Rated M : Minimally Acceptable C : Corrected U : Unacceptable A/W : Acceptable but Monitor & Maintain		+ Issue Type Ma : Maintenance Deficiency Ob : Design & System Obsolescence En : Enforcement	
--	--	---	--	---	--

**Flood Control Project Maintenance
Levee Inspections**

Maintenance Issue Types Only, Levee Inspection Report By Mile - Fall 2021

Reclamation District No. 0003 Grand Island

Waterway	Bank	Unit Miles	Inspection Start/End	Inspector
Unit No. 01 Left Bank Steamboat Slough	Left	10.95	10/06/2021 10/06/2021	David Julian

LM Start	3.01	Rating **	M	Issue No.	145
LM End	3.08	Issue Type +	Ma	Location *	WS
Category	Earthen Levee			GPS Latitude/Longitude	
				Start	End
Item	Vegetation			38.266329 °	38.265260 °
				-121.587125 °	-121.587170 °
DWR ID	DWR_RD0003_01_f_2021_145				
Comment Code					
V1 : Control annual grass and weeds on the levee slopes and easements.					
Inspector Comment					

No Photos

LM Start	3.16	Rating **	N	Issue No.	47
LM End	3.16	Issue Type +	Ma	Location *	WS
Category	Earthen Levee			GPS Latitude/Longitude	
				Start	End
Item	Trim / Thin Trees			38.264154 °	38.264154 °
				-121.587242 °	-121.587242 °
DWR ID	DWR_RD0003_01_s_2012_47				
Comment Code					
T5 : Tree stumps.					
Inspector Comment					
There are 7 large stumps on the slope.					

No Photos

LM Start	3.20	Rating **	M	Issue No.	156
LM End	3.58	Issue Type +	Ma	Location *	LS
Category	Earthen Levee			GPS Latitude/Longitude	
				Start	End
Item	Vegetation			38.263501 °	38.261454 °
				-121.587289 °	-121.593169 °
DWR ID	DWR_RD0003_01_f_2021_156				
Comment Code					
V1 : Control annual grass and weeds on the levee slopes and easements.					
Inspector Comment					

No Photos

* Location		** Rating		+ Issue Type	
LS : Land Side	N/A : Not Applicable	A : Acceptable	N : Not Inspected/Rated	Ma : Maintenance Deficiency	
WS : Water Side		M : Minimally Acceptable	C : Corrected	Ob : Design & System Obsolescence	
CR : Crown		U : Unacceptable	A/W : Acceptable but Monitor & Maintain	En : Enforcement	

**Flood Control Project Maintenance
Levee Inspections**

Maintenance Issue Types Only, Levee Inspection Report By Mile - Fall 2021

Reclamation District No. 0003 Grand Island

Waterway	Bank	Unit Miles	Inspection Start/End	Inspector
Unit No. 01 Left Bank Steamboat Slough	Left	10.95	10/06/2021 10/06/2021	David Julian

LM Start	4.38	Rating **	U	Issue No.	151
LM End	4.38	Issue Type +	Ma	Location *	LS
Category	Earthen Levee			GPS Latitude/Longitude	
				Start	End
Item	Trim / Thin Trees			38.253002 °	38.253002 °
				-121.600715 °	-121.600715 °
DWR ID	DWR_RD0003_01_f_2020_151				
Comment Code					
T2 : Thin trees to allow visibility of the ground and room to flood fight.					
Inspector Comment					

Photo 1 of 1 : FA_2021_RD0003_24_151_20210830_00062.jpg



View of thick palm trees on the landside slope (Fall 2020).

LM Start	4.72	Rating **	C	Issue No.	143
LM End	4.72	Issue Type +	Ma	Location *	LS
Category	Earthen Levee			GPS Latitude/Longitude	
				Start	End
Item	Animal Control			38.248040 °	38.248040 °
				-121.600928 °	-121.600928 °
DWR ID	DWR_RD0003_01_s_2021_143				
Comment Code					
A3 : No rodents visible, but rodent burrows visible; need to backfill and compact or grout burrows.					
Inspector Comment					

No Photos

LM Start	4.87	Rating **	M	Issue No.	83
LM End	4.87	Issue Type +	Ma	Location *	LS
Category	Earthen Levee			GPS Latitude/Longitude	
				Start	End
Item	Slope Stability			38.245903 °	38.245903 °
				-121.600851 °	-121.600851 °
DWR ID	DWR_RD0003_01_f_2017_83				
Comment Code					
S1 : Repair slope instability.					
Inspector Comment					
The landside slope has a depression.					

Photo 1 of 1 : FA_2021_RD0003_24_83_20210830_00040.jpg



Looking east on landside slope.

* Location LS : Land Side N/A : Not Applicable WS : Water Side CR : Crown		** Rating A : Acceptable M : Minimally Acceptable U : Unacceptable		N : Not Inspected/Rated C : Corrected A/W : Acceptable but Monitor & Maintain		+ Issue Type Ma : Maintenance Deficiency Ob : Design & System Obsolescence En : Enforcement	
--	--	--	--	---	--	---	--

**Flood Control Project Maintenance
Levee Inspections**

Maintenance Issue Types Only, Levee Inspection Report By Mile - Fall 2021

Reclamation District No. 0003 Grand Island

Waterway	Bank	Unit Miles	Inspection Start/End	Inspector
Unit No. 01 Left Bank Steamboat Slough	Left	10.95	10/06/2021 10/06/2021	David Julian

LM Start	5.48	Rating **	U	Issue No.	152
LM End	5.48	Issue Type +	Ma	Location *	LS
Category	Earthen Levee			GPS Latitude/Longitude	
				Start	End
Item	Trim / Thin Trees			38.237230 °	38.237230 °
				-121.602252 °	-121.602252 °
DWR ID	DWR_RD0003_01_f_2020_152				
Comment Code					
T2 : Thin trees to allow visibility of the ground and room to flood fight.					
Inspector Comment					

Photo 1 of 1 : FA_2021_RD0003_24_152_20210830_00063.jpg



View of thick trees blocking view down the landside slope (Fall 2020).

LM Start	5.74	Rating **	C	Issue No.	157
LM End	5.74	Issue Type +	Ma	Location *	WS
Category	Earthen Levee			GPS Latitude/Longitude	
				Start	End
Item	Encroachments			38.233543 °	38.233543 °
				-121.601409 °	-121.601409 °
DWR ID	DWR_RD0003_01_s_2021_157				
Comment Code					
PR : Prunings					
Inspector Comment					
Remove prunings on the waterside hinge.					

No Photos

LM Start	6.04	Rating **	M	Issue No.	153
LM End	6.04	Issue Type +	Ma	Location *	LS
Category	Earthen Levee			GPS Latitude/Longitude	
				Start	End
Item	Animal Control			38.229205 °	38.229205 °
				-121.601802 °	-121.601802 °
DWR ID	DWR_RD0003_01_f_2020_153				
Comment Code					
A1 : Exterminate rodents and backfill and compact or grout burrows.					
Inspector Comment					
A couple of rodent holes on the landside slope.					

Photo 1 of 1 : FA_2021_RD0003_24_153_20210830_00064.jpg



View looking up slope at a couple fresh rodent holes in the landside slope (Fall 2020).

* Location LS : Land Side N/A : Not Applicable WS : Water Side CR : Crown		** Rating A : Acceptable M : Minimally Acceptable U : Unacceptable		N : Not Inspected/Rated C : Corrected A/W : Acceptable but Monitor & Maintain		+ Issue Type Ma : Maintenance Deficiency Ob : Design & System Obsolescence En : Enforcement	
--	--	--	--	---	--	---	--

**Flood Control Project Maintenance
Levee Inspections**

Maintenance Issue Types Only, Levee Inspection Report By Mile - Fall 2021

Reclamation District No. 0003 Grand Island

Waterway	Bank	Unit Miles	Inspection Start/End	Inspector
Unit No. 01 Left Bank Steamboat Slough	Left	10.95	10/06/2021 10/06/2021	David Julian

LM Start	6.04	Rating **	M	Issue No.	160
LM End	6.16	Issue Type +	Ma	Location *	LS
Category	Earthen Levee		GPS Latitude/Longitude		
			Start	End	
Item	Vegetation		38.229105 °	38.227360 °	
			-121.601729 °	-121.601598 °	
DWR ID	DWR_RD0003_01_f_2021_160				
Comment Code					
V1 : Control annual grass and weeds on the levee slopes and easements.					
Inspector Comment					

No Photos

LM Start	6.31	Rating **	M	Issue No.	162
LM End	6.58	Issue Type +	Ma	Location *	LS
Category	Earthen Levee		GPS Latitude/Longitude		
			Start	End	
Item	Vegetation		38.225339 °	38.221364 °	
			-121.601316 °	-121.600950 °	
DWR ID	DWR_RD0003_01_f_2021_162				
Comment Code					
V1 : Control annual grass and weeds on the levee slopes and easements.					
Inspector Comment					

No Photos

LM Start	6.62	Rating **	C	Issue No.	158
LM End	6.62	Issue Type +	Ma	Location *	WS
Category	Earthen Levee		GPS Latitude/Longitude		
			Start	End	
Item	Encroachments		38.220757 °	38.220757 °	
			-121.601093 °	-121.601093 °	
DWR ID	DWR_RD0003_01_s_2021_158				
Comment Code					
GA : Garbage					
Inspector Comment					

No Photos

* Location LS : Land Side N/A : Not Applicable WS : Water Side CR : Crown	** Rating A : Acceptable M : Minimally Acceptable U : Unacceptable	N : Not Inspected/Rated C : Corrected A/W : Acceptable but Monitor & Maintain	+ Issue Type Ma : Maintenance Deficiency Ob : Design & System Obsolescence En : Enforcement
--	--	---	---

**Flood Control Project Maintenance
Levee Inspections**

Maintenance Issue Types Only, Levee Inspection Report By Mile - Fall 2021

Reclamation District No. 0003 Grand Island

Waterway	Bank	Unit Miles	Inspection Start/End	Inspector
Unit No. 01 Left Bank Steamboat Slough	Left	10.95	10/06/2021 10/06/2021	David Julian

LM Start	6.86	Rating **	M	Issue No.	163
LM End	7.05	Issue Type +	Ma	Location *	LS
Category	Earthen Levee			GPS Latitude/Longitude	
				Start	End
Item	Vegetation			38.217786 °	38.215277 °
				-121.603202 °	-121.604862 °
DWR ID	DWR_RD0003_01_f_2021_163				
Comment Code					
V1 : Control annual grass and weeds on the levee slopes and easements.					
Inspector Comment					

No Photos

LM Start	7.16	Rating **	M	Issue No.	164
LM End	7.45	Issue Type +	Ma	Location *	WS
Category	Earthen Levee			GPS Latitude/Longitude	
				Start	End
Item	Vegetation			38.213933 °	38.210117 °
				-121.605603 °	-121.607865 °
DWR ID	DWR_RD0003_01_f_2021_164				
Comment Code					
V1 : Control annual grass and weeds on the levee slopes and easements.					
Inspector Comment					

No Photos

LM Start	7.68	Rating **	U	Issue No.	76
LM End	7.68	Issue Type +	Ma	Location *	LS
Category	Earthen Levee			GPS Latitude/Longitude	
				Start	End
Item	Trim / Thin Trees			38.207036 °	38.207036 °
				-121.609540 °	-121.609540 °
DWR ID	DWR_RD0003_01_s_2012_76				
Comment Code					
T2 : Thin trees to allow visibility of the ground and room to flood fight.					
Inspector Comment					

Photo 1 of 1 : FA_2021_RD0003_24_76_20210830_00036.jpg



View of thick tree on the landside slope (Spring 2020).

* Location LS : Land Side N/A : Not Applicable WS : Water Side CR : Crown		** Rating A : Acceptable M : Minimally Acceptable U : Unacceptable		N : Not Inspected/Rated C : Corrected A/W : Acceptable but Monitor & Maintain		+ Issue Type Ma : Maintenance Deficiency Ob : Design & System Obsolescence En : Enforcement	
--	--	--	--	---	--	---	--

**Flood Control Project Maintenance
Levee Inspections**

Maintenance Issue Types Only, Levee Inspection Report By Mile - Fall 2021

Reclamation District No. 0003 Grand Island

Waterway	Bank	Unit Miles	Inspection Start/End	Inspector
Unit No. 01 Left Bank Steamboat Slough	Left	10.95	10/06/2021 10/06/2021	David Julian

LM Start	8.73	Rating **	C	Issue No.	161
LM End	8.73	Issue Type +	Ma	Location *	LS
Category	Earthen Levee			GPS Latitude/Longitude	
				Start	End
Item	Encroachments			38.194016 °	38.194016 °
				-121.617552 °	-121.617552 °
DWR ID	DWR_RD0003_01_s_2021_161				
Comment Code					
TR : Tree or limb					
Inspector Comment					

No Photos

LM Start	8.92	Rating **	N	Issue No.	155
LM End	8.92	Issue Type +	Ma	Location *	WS
Category	Earthen Levee			GPS Latitude/Longitude	
				Start	End
Item	Trim / Thin Trees			38.192985 °	38.192985 °
				-121.620712 °	-121.620712 °
DWR ID	DWR_RD0003_01_f_2020_155				
Comment Code					
T5 : Tree stumps.					
Inspector Comment					
Stump on the waterside hinge.					

Photo 1 of 1 : FA_2021_RD0003_24_155_20210830_00066.jpg



View of tree stump on the waterside slope (Fall 2020).

LM Start	9.08	Rating **	M	Issue No.	166
LM End	9.15	Issue Type +	Ma	Location *	LS
Category	Earthen Levee			GPS Latitude/Longitude	
				Start	End
Item	Vegetation			38.192416 °	38.192265 °
				-121.623567 °	-121.624816 °
DWR ID	DWR_RD0003_01_f_2021_166				
Comment Code					
V1 : Control annual grass and weeds on the levee slopes and easements.					
Inspector Comment					

No Photos

* Location LS : Land Side N/A : Not Applicable WS : Water Side CR : Crown		** Rating A : Acceptable M : Minimally Acceptable U : Unacceptable		N : Not Inspected/Rated C : Corrected A/W : Acceptable but Monitor & Maintain		+ Issue Type Ma : Maintenance Deficiency Ob : Design & System Obsolescence En : Enforcement	
--	--	--	--	---	--	---	--

**Flood Control Project Maintenance
Levee Inspections**

Maintenance Issue Types Only, Levee Inspection Report By Mile - Fall 2021

Reclamation District No. 0003 Grand Island

Waterway	Bank	Unit Miles	Inspection Start/End	Inspector
Unit No. 01 Left Bank Steamboat Slough	Left	10.95	10/06/2021 10/06/2021	David Julian

LM Start	10.13	Rating **	U	Issue No.	74
LM End	10.13	Issue Type +	Ma	Location *	LS
Category	Earthen Levee			GPS Latitude/Longitude	
				Start	End
Item	Vegetation			38.188560 °	38.188560 °
				-121.641283 °	-121.641283 °
DWR ID	DWR_RD0003_01_s_2020_74				
Comment Code					
V2 : Remove the wild growth other than native grasses from the levee slopes.					
Inspector Comment					

Photo 1 of 1 : FA_2021_RD0003_24_74_20210830_00034.jpg



View of vegetation on the landside shoulder and slope (Fall 2020).

LM Start	10.15	Rating **	U	Issue No.	72
LM End	10.21	Issue Type +	Ma	Location *	WS
Category	Earthen Levee			GPS Latitude/Longitude	
				Start	End
Item	Erosion / Bank Caving			38.188431 °	38.187803 °
				-121.641703 °	-121.642478 °
DWR ID	LMA-103				
Comment Code					
E2 : Schedule repair of erosion site prior to the next inspection.					
Inspector Comment					
This was the 2017 Storm Damage site. The waterside slope experienced sloughing and erosion along approximately 312 linear feet. Sloughing commences at approximately 1/4 of the way down the slope from the crown and extends to the rip rap. Site ID No:277 Site Designation:LMA-103 4/9/2020 Field Notes: Relatively significant erosion into waterside slope.					

Photo 1 of 2 : FA_2021_RD0003_24_72_20210830_00031.jpg



38.18866, -121.64134, 25.0m, 4'
Jul 26, 2017 9:58:57 AM

* Location LS : Land Side N/A : Not Applicable WS : Water Side CR : Crown	** Rating A : Acceptable M : Minimally Acceptable U : Unacceptable	N : Not Inspected/Rated C : Corrected A/W : Acceptable but Monitor & Maintain	+ Issue Type Ma : Maintenance Deficiency Ob : Design & System Obsolescence En : Enforcement
--	--	---	---

**Flood Control Project Maintenance
Levee Inspections**

Maintenance Issue Types Only, Levee Inspection Report By Mile - Fall 2021

Reclamation District No. 0003 Grand Island

Waterway	Bank	Unit Miles	Inspection Start/End	Inspector
Unit No. 01 Left Bank Steamboat Slough	Left	10.95	10/06/2021 10/06/2021	David Julian

LM Start	10.15	Rating **	U	Issue No.	72 (cont)
LM End	10.21	Issue Type +	Ma	Location *	WS
Category	Earthen Levee			GPS Latitude/Longitude	
				Start	End
Item	Erosion / Bank Caving			38.188431 °	38.187803 °
				-121.641703 °	-121.642478 °
DWR ID	LMA-103				

Photo 2 of 2 : FA_2021_RD0003_24_72_20210830_00032.jpg



LM Start	10.62	Rating **	C	Issue No.	51
LM End	10.69	Issue Type +	Ma	Location *	WS
Category	Supplemental			GPS Latitude/Longitude	
				Start	End
Item	2018 USACE Erosion Survey			38.184180 °	38.183798 °
				-121.648055 °	-121.649246 °
DWR ID					
Comment Code					
Inspector Comment					
2018 Site ID: STM 15.5 L					
Status: Eroding					
2018 Field Notes: No observed change.					
Site History: 2016 - Large erosion pockets observed.					

No Photos

LM Start	10.64	Rating **	M	Issue No.	45
LM End	10.64	Issue Type +	Ma	Location *	CR
Category	Earthen Levee			GPS Latitude/Longitude	
				Start	End
Item	Encroachments			38.183941 °	38.183941 °
				-121.648242 °	-121.648242 °
DWR ID	DWR_RD0003_01_s_2020_45				
Comment Code					
GA : Garbage					
Inspector Comment					
Remove large pile of bottles on the crown.					

No Photos

* Location LS : Land Side N/A : Not Applicable WS : Water Side CR : Crown		** Rating A : Acceptable M : Minimally Acceptable U : Unacceptable		N : Not Inspected/Rated C : Corrected A/W : Acceptable but Monitor & Maintain		+ Issue Type Ma : Maintenance Deficiency Ob : Design & System Obsolescence En : Enforcement	
--	--	--	--	---	--	---	--

**Flood Control Project Maintenance
Levee Inspections**

Maintenance Issue Types Only, Levee Inspection Report By Mile - Fall 2021

Reclamation District No. 0003 Grand Island

Waterway	Bank	Unit Miles	Inspection Start/End	Inspector
Unit No. 01 Left Bank Steamboat Slough	Left	10.95	10/06/2021 10/06/2021	David Julian

LM Start	10.67	Rating **	C	Issue No.	73
LM End	10.94	Issue Type +	Ma	Location *	WS
Category	Earthen Levee			GPS Latitude/Longitude	
				Start	End
Item	Erosion / Bank Caving			38.183810 °	38.182348 °
				-121.648780 °	-121.653433 °
DWR ID	DWR_RD0003_01_s_2020_73				
Comment Code					
E1 : Note and monitor erosion site.					
Inspector Comment					
Site has been repaired. This was a 2017 Storm Damage site. Scattered erosion scarps caving into levee crown, within erosion limit crown width ranges from 15 to 30', several trees with exposed tree roots and leaning into the river.					
Site ID No:63					
Site Designation:DWR_RD0003_01_R_2012_03					

No Photos

LM Start	10.83	Rating **	M	Issue No.	260	
LM End	10.83	Issue Type +	Ma	Location *		
Category	Supplemental			GPS Latitude/Longitude		
				Start	End	
Item	DWR UCIP LMA Responsibility			38.182982 °	38.182982 °	
				-121.651610 °	-121.651610 °	
DWR ID	22206					
Comment Code						
Inspector Comment						
DS_ID:22206 FS_ID:69662 EP_NO: N/A Repair Type: Non-Urgent EVAL Issue: Unauthorized Encroachment, installed decades prior Crossing Status: Found UCIP Comments: 05/22/2020 Record remains Non-Urgent due to missing permit and crossing being abandoned. (S. Donovan - DWR UCIP)02/11/2014 Pipe appears abandoned and should be verified as having been done so properly. (G. Wylie - DWR UCIP) FIELD_STRUCT_DESC: *ABANDONED* 36-inch corrugated metal drainage pipe through the levee, 15.0 feet below the crown. Slide gate in a 48-inch corrugated metal pipe (CMP) riser on the waterside (WS) shoulder. Flap gate at the WS toe has been sealed shut with sealant. [Additional Reference(s): DWR Levee Log, 1993, (HLM 10.90), referenced as 24.0 feet below the crown. USACE Sacramento O&M Manual 104, February 1960, (RM 15.20), referenced as invert elevation 24.0 feet below the crown]. FS Date: 5/22/2020 8:07:00 AM						

Photo 1 of 3 : UCIP_FA_2021_69662_85972.jpg



Overview of the levee crown looking d/s.

* Location LS : Land Side N/A : Not Applicable WS : Water Side CR : Crown		** Rating A : Acceptable M : Minimally Acceptable U : Unacceptable N : Not Inspected/Rated C : Corrected A/W : Acceptable but Monitor & Maintain		+ Issue Type Ma : Maintenance Deficiency Ob : Design & System Obsolescence En : Enforcement	
--	--	---	--	---	--

**Flood Control Project Maintenance
Levee Inspections**

Maintenance Issue Types Only, Levee Inspection Report By Mile - Fall 2021

Reclamation District No. 0003 Grand Island

Waterway	Bank	Unit Miles	Inspection Start/End	Inspector
Unit No. 01 Left Bank Steamboat Slough	Left	10.95	10/06/2021 10/06/2021	David Julian

LM Start	10.83	Rating **	M	Issue No.	260 (cont)
LM End	10.83	Issue Type +	Ma	Location *	
Category	Supplemental			GPS Latitude/Longitude	
				Start	End
Item	DWR UCIP LMA Responsibility			38.182982 °	38.182982 °
				-121.651610 °	-121.651610 °
DWR ID	22206				

Photo 2 of 3 : UCIP_FA_2021_69662_85967.jpg



LS view: Steel weir on the levee toe.

LM Start	10.83	Rating **	M	Issue No.	260 (cont)
LM End	10.83	Issue Type +	Ma	Location *	

Photo 3 of 3 : UCIP_FA_2021_69662_85968.jpg



WS view: Standpipe on the levee shoulder.

* Location LS : Land Side N/A : Not Applicable WS : Water Side CR : Crown		** Rating A : Acceptable N : Not Inspected/Rated M : Minimally Acceptable C : Corrected U : Unacceptable A/W : Acceptable but Monitor & Maintain		+ Issue Type Ma : Maintenance Deficiency Ob : Design & System Obsolescence En : Enforcement
--	--	---	--	---

**Flood Control Project Maintenance
Levee Inspections**

Maintenance Issue Types Only, Levee Inspection Report By Mile - Fall 2021

Reclamation District No. 0003 Grand Island

Waterway	Bank	Unit Miles	Inspection Start/End	Inspector
Unit No. 01 Left Bank Steamboat Slough	Left	10.95	10/06/2021 10/06/2021	David Julian

LM Start	10.83	Rating **	M	Issue No.	261
LM End	10.83	Issue Type +	Ma	Location *	
Category	Supplemental			GPS Latitude/Longitude	
				Start	End
Item	DWR UCIP LMA Responsibility			38.182973 °	38.182973 °
				-121.651645 °	-121.651645 °
DWR ID	22349				

Comment Code

Inspector Comment

DS_ID:22349
FS_ID:69663
EP_NO: N/A
Repair Type: Non-Urgent
EVAL Issue: Unauthorized Encroachment, installed decades prior
Crossing Status: Found
UCIP Comments: 05/22/2020 Record remains Non-Urgent due to missing permit and crossing being abandoned. (S. Donovan - DWR UCIP)02/11/2014 Pipe appears abandoned and should be verified as having been filled with grout. (G. Wylie - DWR UCIP)
FIELD_STRUCT_DESC: *ABANDONED* 36-inch corrugated metal drainage pipe through the levee, 15.0 feet below the crown. Slide gate in a 48-inch corrugated metal pipe (CMP) riser on the waterside (WS) shoulder. Steel intake weir at the landside (LS) toe. Steel plate welded over the pipe on the WS toe. [Additional Reference(s): DWR Levee Log, 1993, (HLM 10.90), referenced as 24.0 feet below the crown. USACE Sacramento O&M Manual 104, February 1960, (RM 15.20), referenced as invert elevation 24.0 feet below the crown].
FS Date: 5/22/2020 8:28:00 AM

LM Start	10.83	Rating **	M	Issue No.	261 (cont)
LM End	10.83	Issue Type +	Ma	Location *	

Photo 1 of 3 : UCIP_FA_2021_69663_85978.jpg



Overview of the levee crown looking d/s.

Photo 2 of 3 : UCIP_FA_2021_69663_85973.jpg



LS view: Steel weir on the levee toe.

* Location	** Rating	+ Issue Type
LS : Land Side WS : Water Side CR : Crown	A : Acceptable M : Minimally Acceptable U : Unacceptable	Ma : Maintenance Deficiency Ob : Design & System Obsolescence En : Enforcement
N/A : Not Applicable	N : Not Inspected/Rated C : Corrected A/W : Acceptable but Monitor & Maintain	

**Flood Control Project Maintenance
Levee Inspections**

Maintenance Issue Types Only, Levee Inspection Report By Mile - Fall 2021

Reclamation District No. 0003 Grand Island

Waterway	Bank	Unit Miles	Inspection Start/End	Inspector
Unit No. 01 Left Bank Steamboat Slough	Left	10.95	10/06/2021 10/06/2021	David Julian

LM Start	10.83	Rating **	M	Issue No.	261 (cont)
LM End	10.83	Issue Type +	Ma	Location *	
Category	Supplemental			GPS Latitude/Longitude	
				Start	End
Item	DWR UCIP LMA Responsibility			38.182973 °	38.182973 °
				-121.651645 °	-121.651645 °
DWR ID	22349				

Photo 3 of 3 : UCIP_FA_2021_69663_85974.jpg



WS view: Standpipe on the levee shoulder.

* Location LS : Land Side N/A : Not Applicable WS : Water Side CR : Crown	** Rating A : Acceptable M : Minimally Acceptable U : Unacceptable N : Not Inspected/Rated C : Corrected A/W : Acceptable but Monitor & Maintain	+ Issue Type Ma : Maintenance Deficiency Ob : Design & System Obsolescence En : Enforcement
--	---	---

**Flood Control Project Maintenance
Levee Inspections**

Maintenance Issue Types Only, Levee Inspection Report By Mile - Fall 2021

Reclamation District No. 0003 Grand Island

Waterway	Bank	Unit Miles	Inspection Start/End	Inspector
Unit No. 02 Right Bank Sacramento River	Right	17.35	10/05/2021 10/06/2021	David Julian

LM Start	0.04	Rating **	C	Issue No.	225
LM End	0.10	Issue Type +	Ma	Location *	CR
Category	Earthen Levee			GPS Latitude/Longitude	
				Start	End
Item	Vegetation			38.175636 °	38.175250 °
				-121.653275 °	-121.652235 °
DWR ID	DWR_RD0003_02_s_2020_225				
Comment Code					
V9 : Keep the crown roadway free of vegetation.					
Inspector Comment					

No Photos

LM Start	0.30	Rating **	C	Issue No.	5
LM End	0.32	Issue Type +	Ma	Location *	WS
Category	Earthen Levee			GPS Latitude/Longitude	
				Start	End
Item	Vegetation			38.174281 °	38.174209 °
				-121.648698 °	-121.648352 °
DWR ID	DWR_RD0003_02_s_2019_5				
Comment Code					
V2 : Remove the wild growth other than native grasses from the levee slopes.					
Inspector Comment					

No Photos

LM Start	0.31	Rating **	M	Issue No.	68
LM End	0.35	Issue Type +	Ma	Location *	LS
Category	Earthen Levee			GPS Latitude/Longitude	
				Start	End
Item	Vegetation			38.174261 °	38.174111 °
				-121.648583 °	-121.647863 °
DWR ID	DWR_RD0003_02_f_2021_68				
Comment Code					
V2 : Remove the wild growth other than native grasses from the levee slopes.					
Inspector Comment					
Willows on the landside slope					

Photo 1 of 1 : FA_2021_RD0003_25_68_20211006_00279.jpg



View of willows on the landside slope (Fall 2021).

* Location LS : Land Side N/A : Not Applicable WS : Water Side CR : Crown		** Rating A : Acceptable M : Minimally Acceptable U : Unacceptable N : Not Inspected/Rated C : Corrected A/W : Acceptable but Monitor & Maintain		+ Issue Type Ma : Maintenance Deficiency Ob : Design & System Obsolescence En : Enforcement	
--	--	---	--	---	--

**Flood Control Project Maintenance
Levee Inspections**

Maintenance Issue Types Only, Levee Inspection Report By Mile - Fall 2021

Reclamation District No. 0003 Grand Island

Waterway	Bank	Unit Miles	Inspection Start/End	Inspector
Unit No. 02 Right Bank Sacramento River	Right	17.35	10/05/2021 10/06/2021	David Julian

LM Start	0.37	Rating **	C	Issue No.	3
LM End	0.37	Issue Type +	Ma	Location *	WS
Category	Earthen Levee			GPS Latitude/Longitude	
				Start	End
Item	Vegetation			38.174020 °	38.174020 °
				-121.647458 °	-121.647458 °
DWR ID	DWR_RD0003_02_f _ 2018_3				
Comment Code					
V2 : Remove the wild growth other than native grasses from the levee slopes.					
Inspector Comment					

No Photos

LM Start	0.70	Rating **	M	Issue No.	160
LM End	0.70	Issue Type +	Ma	Location *	LS
Category	Earthen Levee			GPS Latitude/Longitude	
				Start	End
Item	Encroachments			38.173455 °	38.173455 °
				-121.641456 °	-121.641456 °
DWR ID	DWR_RD0003_02_f_2021_160				
Comment Code					
TR : Tree or limb					
Inspector Comment					

No Photos

LM Start	1.53	Rating **	M	Issue No.	222
LM End	1.53	Issue Type +	Ma	Location *	WS
Category	Earthen Levee			GPS Latitude/Longitude	
				Start	End
Item	Encroachments			38.168908 °	38.168908 °
				-121.627748 °	-121.627748 °
DWR ID	DWR_RD0003_02_f_2019_222				
Comment Code					
GA : Garbage					
Inspector Comment					
Remove discarded chair from waterside slope.					

Photo 1 of 1 : FA_2021_RD0003_25_222_20210830_00119.jpg



View of discarded chair on the waterside slope (Spring 2021).

* Location LS : Land Side N/A : Not Applicable WS : Water Side CR : Crown		** Rating A : Acceptable M : Minimally Acceptable U : Unacceptable N : Not Inspected/Rated C : Corrected A/W : Acceptable but Monitor & Maintain		+ Issue Type Ma : Maintenance Deficiency Ob : Design & System Obsolescence En : Enforcement	
--	--	---	--	---	--

**Flood Control Project Maintenance
Levee Inspections**

Maintenance Issue Types Only, Levee Inspection Report By Mile - Fall 2021

Reclamation District No. 0003 Grand Island

Waterway	Bank	Unit Miles	Inspection Start/End	Inspector
Unit No. 02 Right Bank Sacramento River	Right	17.35	10/05/2021 10/06/2021	David Julian

LM Start	2.44	Rating **	M	Issue No.	163
LM End	2.44	Issue Type +	Ma	Location *	LS
Category	Earthen Levee			GPS Latitude/Longitude	
				Start	End
Item	Trim / Thin Trees			38.164342 °	38.164342 °
				-121.612455 °	-121.612455 °
DWR ID	DWR_RD0003_02_f_2020_163				
Comment Code					
T2 : Thin trees to allow visibility of the ground and room to flood fight.					
Inspector Comment					

Photo 1 of 1 : FA_2021_RD0003_25_163_20210830_00090.jpg



View of trees partially blocking the view down the landside slope (Fall 2020).

LM Start	2.75	Rating **	U	Issue No.	224	
LM End	2.75	Issue Type +	Ma	Location *	LS	
Category	Earthen Levee			GPS Latitude/Longitude		
				Start		End
Item	Encroachments			38.164814 °		38.164814 °
				-121.606704 °		-121.606704 °
DWR ID	DWR_RD0003_02_f_2021_224					
Comment Code						
PR : Prunings						
Inspector Comment						

Photo 1 of 1 : FA_2021_RD0003_25_224_20211006_00281.jpg



View of tree prunings on the landside toe (Fall 2021).

LM Start	2.89	Rating **	M	Issue No.	226
LM End	3.02	Issue Type +	Ma	Location *	LS
Category	Earthen Levee			GPS Latitude/Longitude	
				Start	End
Item	Vegetation			38.165367 °	38.166303 °
				-121.604260 °	-121.602151 °
DWR ID	DWR_RD0003_02_f_2021_226				
Comment Code					
V1 : Control annual grass and weeds on the levee slopes and easements.					
Inspector Comment					

No Photos

* Location		** Rating		+ Issue Type	
LS : Land Side	N/A : Not Applicable	A : Acceptable	N : Not Inspected/Rated	Ma : Maintenance Deficiency	
WS : Water Side		M : Minimally Acceptable	C : Corrected	Ob : Design & System Obsolescence	
CR : Crown		U : Unacceptable	A/W : Acceptable but Monitor & Maintain	En : Enforcement	

**Flood Control Project Maintenance
Levee Inspections**

Maintenance Issue Types Only, Levee Inspection Report By Mile - Fall 2021

Reclamation District No. 0003 Grand Island

Waterway	Bank	Unit Miles	Inspection Start/End	Inspector
Unit No. 02 Right Bank Sacramento River	Right	17.35	10/05/2021 10/06/2021	David Julian

LM Start	3.08	Rating **	M	Issue No.	227
LM End	3.08	Issue Type +	Ma	Location *	WS
Category	Earthen Levee			GPS Latitude/Longitude	
				Start	End
Item	Encroachments			38.166766 °	38.166766 °
				-121.601321 °	-121.601321 °
DWR ID	DWR_RD0003_02_f_2021_227				
Comment Code					
GA : Garbage					
Inspector Comment					
Remove garbage pile from the waterside hinge.					

Photo 1 of 1 : FA_2021_RD0003_25_227_20211006_00282.jpg



View looking downstream at garbage on the waterside hinge (Fall 2021).

LM Start	3.08	Rating **	M	Issue No.	228
LM End	3.08	Issue Type +	Ma	Location *	LS
Category	Earthen Levee			GPS Latitude/Longitude	
				Start	End
Item	Slope Stability			38.166805 °	38.166805 °
				-121.601264 °	-121.601264 °
DWR ID	DWR_RD0003_02_f_2021_228				
Comment Code					
S3 : Repair the levee slope damaged by vehicle traffic and prevent access where possible.					
Inspector Comment					
Vehicle spin out divits in the landside hinge.					

Photo 1 of 1 : FA_2021_RD0003_25_228_20211006_00283.jpg



View of vehicle divots in the landside hinge (Fall 2021).

LM Start	3.40	Rating **	C	Issue No.	132
LM End	3.40	Issue Type +	Ma	Location *	LS
Category	Earthen Levee			GPS Latitude/Longitude	
				Start	End
Item	Encroachments			38.169880 °	38.169880 °
				-121.596911 °	-121.596911 °
DWR ID	DWR_RD0003_02_s_2021_132				
Comment Code					
TR : Tree or limb					
Inspector Comment					

No Photos

* Location		** Rating		+ Issue Type	
LS : Land Side	N/A : Not Applicable	A : Acceptable	N : Not Inspected/Rated	Ma : Maintenance Deficiency	
WS : Water Side		M : Minimally Acceptable	C : Corrected	Ob : Design & System Obsolescence	
CR : Crown		U : Unacceptable	A/W : Acceptable but Monitor & Maintain	En : Enforcement	

**Flood Control Project Maintenance
Levee Inspections**

Maintenance Issue Types Only, Levee Inspection Report By Mile - Fall 2021

Reclamation District No. 0003 Grand Island

Waterway	Bank	Unit Miles	Inspection Start/End	Inspector
Unit No. 02 Right Bank Sacramento River	Right	17.35	10/05/2021 10/06/2021	David Julian

LM Start	3.44	Rating **	M	Issue No.	180
LM End	3.44	Issue Type +	Ma	Location *	LS
Category	Earthen Levee			GPS Latitude/Longitude	
				Start	End
Item	Encroachments			38.170293 °	38.170293 °
				-121.596497 °	-121.596497 °
DWR ID	DWR_RD0003_02_s_2018_180				
Comment Code					
TR : Tree or limb					
Inspector Comment					
Fallen tree at landside toe blocks access.					

Photo 1 of 1 : FA_2021_RD0003_25_180_20210830_00102.jpg



Fallen tree at landside toe should be removed.

LM Start	3.78	Rating **	U	Issue No.	200
LM End	3.78	Issue Type +	Ma	Location *	LS
Category	Earthen Levee			GPS Latitude/Longitude	
				Start	End
Item	Vegetation			38.174550 °	38.174550 °
				-121.593345 °	-121.593345 °
DWR ID	DWR_RD0003_02_f_2018_200				
Comment Code					
V2 : Remove the wild growth other than native grasses from the levee slopes.					
Inspector Comment					
Remove the arundo growth.					

Photo 1 of 1 : FA_2021_RD0003_25_200_20210830_00111.jpg



View of arundo growth on the landside slope (October 2018).

LM Start	4.56	Rating **	U	Issue No.	217
LM End	4.56	Issue Type +	Ma	Location *	LS
Category	Earthen Levee			GPS Latitude/Longitude	
				Start	End
Item	Trim / Thin Trees			38.184338 °	38.184338 °
				-121.585941 °	-121.585941 °
DWR ID	DWR_RD0003_02_f_2021_217				
Comment Code					
T2 : Thin trees to allow visibility of the ground and room to flood fight.					
Inspector Comment					

Photo 1 of 1 : FA_2021_RD0003_25_217_20211014_00307.jpg



View of thick tree on the landside slope (Fall 2021).

* Location LS : Land Side N/A : Not Applicable WS : Water Side CR : Crown		** Rating A : Acceptable M : Minimally Acceptable U : Unacceptable		N : Not Inspected/Rated C : Corrected A/W : Acceptable but Monitor & Maintain		+ Issue Type Ma : Maintenance Deficiency Ob : Design & System Obsolescence En : Enforcement	
--	--	--	--	---	--	---	--

**Flood Control Project Maintenance
Levee Inspections**

Maintenance Issue Types Only, Levee Inspection Report By Mile - Fall 2021

Reclamation District No. 0003 Grand Island

Waterway	Bank	Unit Miles	Inspection Start/End	Inspector
Unit No. 02 Right Bank Sacramento River	Right	17.35	10/05/2021 10/06/2021	David Julian

LM Start	4.94	Rating **	M	Issue No.	194
LM End	4.94	Issue Type +	Ma	Location *	WS
Category	Earthen Levee			GPS Latitude/Longitude	
				Start	End
Item	Erosion / Bank Caving			38.188248 °	38.188248 °
				-121.581225 °	-121.581225 °
DWR ID	DWR_RD0003_02_s_2019_194				
Comment Code					
E2 : Schedule repair of erosion site prior to the next inspection.					
Inspector Comment					
Small amount of bank caving.					

Photo 1 of 1 : FA_2021_RD0003_25_194_20210830_00109.jpg



View looking downslope at erosion on the waterside slope (Spring 2019).

LM Start	4.95	Rating **	U	Issue No.	14
LM End	4.95	Issue Type +	Ma	Location *	LS
Category	Earthen Levee			GPS Latitude/Longitude	
				Start	End
Item	Trim / Thin Trees			38.188526 °	38.188526 °
				-121.581179 °	-121.581179 °
DWR ID	DWR_RD0003_02_f_2020_14				
Comment Code					
T2 : Thin trees to allow visibility of the ground and room to flood fight.					
Inspector Comment					
There are untrimmed trees on the landside slope and toe.					

Photo 1 of 1 : FA_2021_RD0003_25_14_20210830_00008.jpg



View of untrimmed trees on the landside slope (Fall 2020).

LM Start	4.96	Rating **	A/W	Issue No.	1
LM End	4.96	Issue Type +	Ma	Location *	WS
Category	Earthen Levee			GPS Latitude/Longitude	
				Start	End
Item	Slope Stability			38.188420 °	38.188420 °
				-121.580910 °	-121.580910 °
DWR ID	DWR_RD0003_02_s_2020_1				
Comment Code					
S1 : Repair slope instability.					
Inspector Comment					
Waterside slope bowed in slightly, indicating possible slope instability.					

Photo 1 of 1 : FA_2021_RD0003_25_1_20210830_00001.jpg



View from the channel of slightly bowing into the waterside slope (Summer 2020).

* Location		** Rating		+ Issue Type	
LS : Land Side	N/A : Not Applicable	A : Acceptable	N : Not Inspected/Rated	Ma : Maintenance Deficiency	
WS : Water Side		M : Minimally Acceptable	C : Corrected	Ob : Design & System Obsolescence	
CR : Crown		U : Unacceptable	A/W : Acceptable but Monitor & Maintain	En : Enforcement	

**Flood Control Project Maintenance
Levee Inspections**

Maintenance Issue Types Only, Levee Inspection Report By Mile - Fall 2021

Reclamation District No. 0003 Grand Island

Waterway	Bank	Unit Miles	Inspection Start/End	Inspector
Unit No. 02 Right Bank Sacramento River	Right	17.35	10/05/2021 10/06/2021	David Julian

LM Start	5.17	Rating **	M	Issue No.	214
LM End	6.40	Issue Type +	Ma	Location *	LS
Category	Earthen Levee			GPS Latitude/Longitude	
				Start	End
Item	Vegetation			38.190236 °	38.199518 °
				-121.577912 °	-121.559687 °
DWR ID	DWR_RD0003_02_f_2021_214				
Comment Code					
V1 : Control annual grass and weeds on the levee slopes and easements.					
Inspector Comment					

No Photos

LM Start	6.59	Rating **	M	Issue No.	213
LM End	8.17	Issue Type +	Ma	Location *	LS
Category	Earthen Levee			GPS Latitude/Longitude	
				Start	End
Item	Vegetation			38.202150 °	38.225070 °
				-121.558792 °	-121.557290 °
DWR ID	DWR_RD0003_02_f_2021_213				
Comment Code					
V1 : Control annual grass and weeds on the levee slopes and easements.					
Inspector Comment					

No Photos

LM Start	7.01	Rating **	U	Issue No.	16
LM End	7.01	Issue Type +	Ma	Location *	LS
Category	Earthen Levee			GPS Latitude/Longitude	
				Start	End
Item	Trim / Thin Trees			38.208205 °	38.208205 °
				-121.558565 °	-121.558565 °
DWR ID	DWR_RD0003_02_s_2012_16				
Comment Code					
T2 : Thin trees to allow visibility of the ground and room to flood fight.					
Inspector Comment					

Photo 1 of 1 : FA_2021_RD0003_25_16_20210830_00010.jpg



View of thick vegetation at the landside toe (Fall 2019).

* Location LS : Land Side N/A : Not Applicable WS : Water Side CR : Crown	** Rating A : Acceptable M : Minimally Acceptable U : Unacceptable	N : Not Inspected/Rated C : Corrected A/W : Acceptable but Monitor & Maintain	+ Issue Type Ma : Maintenance Deficiency Ob : Design & System Obsolescence En : Enforcement
--	--	---	---

**Flood Control Project Maintenance
Levee Inspections**

Maintenance Issue Types Only, Levee Inspection Report By Mile - Fall 2021

Reclamation District No. 0003 Grand Island

Waterway	Bank	Unit Miles	Inspection Start/End	Inspector
Unit No. 02 Right Bank Sacramento River	Right	17.35	10/05/2021 10/06/2021	David Julian

LM Start	7.08	Rating **	U	Issue No.	152
LM End	7.08	Issue Type +	Ma	Location *	LS
Category	Earthen Levee			GPS Latitude/Longitude	
				Start	End
Item	Trim / Thin Trees			38.209252 °	38.209252 °
				-121.558611 °	-121.558611 °
DWR ID	DWR_RD0003_02_f_2020_152				
Comment Code					
T2 : Thin trees to allow visibility of the ground and room to flood fight.					
Inspector Comment					

Photo 1 of 1 : FA_2021_RD0003_25_152_20210830_00081.jpg



View of thick trees on the landside slope (Fall 2020).

LM Start	7.45	Rating **	U	Issue No.	173
LM End	7.45	Issue Type +	Ma	Location *	LS
Category	Earthen Levee			GPS Latitude/Longitude	
				Start	End
Item	Encroachments			38.214600 °	38.214600 °
				-121.558612 °	-121.558612 °
DWR ID	DWR_RD0003_02_s_2021_173				
Comment Code					
TR : Tree or limb					
Inspector Comment					
Remove down tree on the landside slope.					

Photo 1 of 1 : FA_2021_RD0003_25_173_20210830_00097.jpg



View of down tree limb on the landside slope (Spring 2021).

LM Start	8.11	Rating **	U	Issue No.	15
LM End	8.11	Issue Type +	Ma	Location *	WS
Category	Earthen Levee			GPS Latitude/Longitude	
				Start	End
Item	Encroachments			38.224130 °	38.224130 °
				-121.557206 °	-121.557206 °
DWR ID	DWR_RD0003_02_f_2020_15				
Comment Code					
TR : Tree or limb					
Inspector Comment					
Remove broken tree branches on waterside shoulder and slope.					

Photo 1 of 1 : FA_2021_RD0003_25_15_20210830_00009.jpg



View of fallen tree limb on the waterside slope (Fall 2020).

* Location		** Rating		+ Issue Type	
LS : Land Side	N/A : Not Applicable	A : Acceptable	N : Not Inspected/Rated	Ma : Maintenance Deficiency	
WS : Water Side		M : Minimally Acceptable	C : Corrected	Ob : Design & System Obsolescence	
CR : Crown		U : Unacceptable	A/W : Acceptable but Monitor & Maintain	En : Enforcement	

**Flood Control Project Maintenance
Levee Inspections**

Maintenance Issue Types Only, Levee Inspection Report By Mile - Fall 2021

Reclamation District No. 0003 Grand Island

Waterway	Bank	Unit Miles	Inspection Start/End	Inspector
Unit No. 02 Right Bank Sacramento River	Right	17.35	10/05/2021 10/06/2021	David Julian

LM Start	8.42	Rating **	M	Issue No.	212
LM End	8.70	Issue Type +	Ma	Location *	LS
Category	Earthen Levee			GPS Latitude/Longitude	
				Start	End
Item	Vegetation			38.228574 °	38.232461 °
				-121.557134 °	-121.558801 °
DWR ID	DWR_RD0003_02_f_2021_212				
Comment Code					
V1 : Control annual grass and weeds on the levee slopes and easements.					
Inspector Comment					

No Photos

LM Start	8.72	Rating **	U	Issue No.	167
LM End	8.72	Issue Type +	Ma	Location *	LS
Category	Earthen Levee			GPS Latitude/Longitude	
				Start	End
Item	Animal Control			38.232673 °	38.232673 °
				-121.558935 °	-121.558935 °
DWR ID	DWR_RD0003_02_s_2021_167				
Comment Code					
A3 : No rodents visible, but rodent burrows visible; need to backfill and compact or grout burrows.					
Inspector Comment					
Multiple fresh rodent holes.					

Photo 1 of 1 : FA_2021_RD0003_25_167_20210830_00093.jpg



View of multiple rodent holes in the landside slope (Spring 2021).

LM Start	8.95	Rating **	M	Issue No.	209
LM End	8.95	Issue Type +	Ma	Location *	LS
Category	Earthen Levee			GPS Latitude/Longitude	
				Start	End
Item	Trim / Thin Trees			38.236011 °	38.236011 °
				-121.559624 °	-121.559624 °
DWR ID	DWR_RD0003_02_f_2021_209				
Comment Code					
T1 : Trim trees to at least five feet above ground level.					
Inspector Comment					

No Photos

* Location		** Rating		+ Issue Type	
LS : Land Side WS : Water Side CR : Crown		A : Acceptable M : Minimally Acceptable U : Unacceptable		Ma : Maintenance Deficiency Ob : Design & System Obsolescence En : Enforcement	
N/A : Not Applicable		N : Not Inspected/Rated C : Corrected A/W : Acceptable but Monitor & Maintain			

**Flood Control Project Maintenance
Levee Inspections**

Maintenance Issue Types Only, Levee Inspection Report By Mile - Fall 2021

Reclamation District No. 0003 Grand Island

Waterway	Bank	Unit Miles	Inspection Start/End	Inspector
Unit No. 02 Right Bank Sacramento River	Right	17.35	10/05/2021 10/06/2021	David Julian

LM Start	9.74	Rating **	M	Issue No.	206
LM End	9.74	Issue Type +	Ma	Location *	LS
Category	Earthen Levee			GPS Latitude/Longitude	
				Start	End
Item	Slope Stability			38.242332 °	38.242332 °
				-121.549485 °	-121.549485 °
DWR ID	DWR_RD0003_02_f_2021_206				
Comment Code					
S1 : Repair slope instability.					
Inspector Comment					
Landside slope getting close to edge of roadway. Slight cracking in roadway.					

Photo 1 of 1 : FA_2021_RD0003_25_206_20211014_00304.jpg



View of depression in the landside slope getting close to the roadway (Fall 2021).

LM Start	10.01	Rating **	M	Issue No.	138
LM End	10.03	Issue Type +	Ma	Location *	WS
Category	Earthen Levee			GPS Latitude/Longitude	
				Start	End
Item	Erosion / Bank Caving			38.241481 °	38.241439 °
				-121.544569 °	-121.544353 °
DWR ID	LMA-106				
Comment Code					
E2 : Schedule repair of erosion site prior to the next inspection.					
Inspector Comment					
This was a 2017 Storm Damage site. Site ID No:280 Site Designation:LMA-106 6/18/2020 Field Notes: Approximately 2' vertical erosion on surface of waterside slope. The erosion commences approximately 1/2 of the way down the slope from the crown and extends into the riprap. Missing riprap at this location.					

Photo 1 of 1 : FA_2021_RD0003_25_138_20210830_00071.jpg



View from the channel at erosion on the waterside (Summer 2020).

* Location LS : Land Side N/A : Not Applicable WS : Water Side CR : Crown		** Rating A : Acceptable M : Minimally Acceptable U : Unacceptable N : Not Inspected/Rated C : Corrected A/W : Acceptable but Monitor & Maintain		+ Issue Type Ma : Maintenance Deficiency Ob : Design & System Obsolescence En : Enforcement	
--	--	---	--	---	--

**Flood Control Project Maintenance
Levee Inspections**

Maintenance Issue Types Only, Levee Inspection Report By Mile - Fall 2021

Reclamation District No. 0003 Grand Island

Waterway	Bank	Unit Miles	Inspection Start/End	Inspector
Unit No. 02 Right Bank Sacramento River	Right	17.35	10/05/2021 10/06/2021	David Julian

LM Start	10.01	Rating **	C	Issue No.	169
LM End	10.01	Issue Type +	Ma	Location *	LS
Category	Earthen Levee			GPS Latitude/Longitude	
				Start	End
Item	Encroachments			38.241624 °	38.241624 °
				-121.544520 °	-121.544520 °
DWR ID	DWR_RD0003_02_s_2020_169				
Comment Code					
TR : Tree or limb					
Inspector Comment					

No Photos

LM Start	10.15	Rating **	M	Issue No.	170
LM End	10.15	Issue Type +	Ma	Location *	LS
Category	Earthen Levee			GPS Latitude/Longitude	
				Start	End
Item	Encroachments			38.241125 °	38.241125 °
				-121.542075 °	-121.542075 °
DWR ID	DWR_RD0003_02_s_2018_170				
Comment Code					
TR : Tree or limb					
Inspector Comment					
There is a fallen tree on the landside slope.					

Photo 1 of 1 : FA_2021_RD0003_25_170_20210830_00095.jpg



Fallen tree on landside slope.

LM Start	10.17	Rating **	U	Issue No.	145
LM End	10.18	Issue Type +	Ma	Location *	LS
Category	Earthen Levee			GPS Latitude/Longitude	
				Start	End
Item	Vegetation			38.241075 °	38.241027 °
				-121.541843 °	-121.541633 °
DWR ID	DWR_RD0003_02_s_2021_145				
Comment Code					
V2 : Remove the wild growth other than native grasses from the levee slopes.					
Inspector Comment					
Arundo on the landside slope.					

Photo 1 of 1 : FA_2021_RD0003_25_145_20210830_00075.jpg



View of thick arundo on the landside slope (Spring 2021).

* Location LS : Land Side N/A : Not Applicable WS : Water Side CR : Crown		** Rating A : Acceptable M : Minimally Acceptable U : Unacceptable		+ Issue Type Ma : Maintenance Deficiency Ob : Design & System Obsolescence En : Enforcement	
		N : Not Inspected/Rated C : Corrected A/W : Acceptable but Monitor & Maintain			

**Flood Control Project Maintenance
Levee Inspections**

Maintenance Issue Types Only, Levee Inspection Report By Mile - Fall 2021

Reclamation District No. 0003 Grand Island

Waterway	Bank	Unit Miles	Inspection Start/End	Inspector
Unit No. 02 Right Bank Sacramento River	Right	17.35	10/05/2021 10/06/2021	David Julian

LM Start	10.17	Rating **	M	Issue No.	148
LM End	10.17	Issue Type +	Ma	Location *	LS
Category	Earthen Levee			GPS Latitude/Longitude	
				Start	End
Item	Encroachments			38.241060 °	38.241060 °
				-121.541700 °	-121.541700 °
DWR ID	DWR_RD0003_02_s_2021_148				
Comment Code					
TR : Tree or limb					
Inspector Comment					
Remove tree limb on the landside hinge.					

Photo 1 of 1 : FA_2021_RD0003_25_148_20210830_00078.jpg



View of down tree limb on the landside hinge (Spring 2021).

LM Start	10.36	Rating **	M	Issue No.	204
LM End	10.72	Issue Type +	Ma	Location *	LS
Category	Earthen Levee			GPS Latitude/Longitude	
				Start	End
Item	Vegetation			38.240249 °	38.238834 °
				-121.538425 °	-121.532101 °
DWR ID	DWR_RD0003_02_f_2021_204				
Comment Code					
V1 : Control annual grass and weeds on the levee slopes and easements.					
Inspector Comment					

No Photos

LM Start	10.88	Rating **	M	Issue No.	164
LM End	10.88	Issue Type +	Ma	Location *	WS
Category	Earthen Levee			GPS Latitude/Longitude	
				Start	End
Item	Vegetation			38.238861 °	38.238861 °
				-121.529074 °	-121.529074 °
DWR ID	DWR_RD0003_02_f_2017_164				
Comment Code					
V2 : Remove the wild growth other than native grasses from the levee slopes.					
Inspector Comment					
A century plant is on the waterside.					

No Photos

* Location LS : Land Side N/A : Not Applicable WS : Water Side CR : Crown		** Rating A : Acceptable M : Minimally Acceptable U : Unacceptable N : Not Inspected/Rated C : Corrected A/W : Acceptable but Monitor & Maintain		+ Issue Type Ma : Maintenance Deficiency Ob : Design & System Obsolescence En : Enforcement	
--	--	---	--	---	--

**Flood Control Project Maintenance
Levee Inspections**

Maintenance Issue Types Only, Levee Inspection Report By Mile - Fall 2021

Reclamation District No. 0003 Grand Island

Waterway	Bank	Unit Miles	Inspection Start/End	Inspector
Unit No. 02 Right Bank Sacramento River	Right	17.35	10/05/2021 10/06/2021	David Julian

LM Start	11.26	Rating **	M	Issue No.	201
LM End	11.26	Issue Type +	Ma	Location *	WS
Category	Earthen Levee			GPS Latitude/Longitude	
				Start	End
Item	Encroachments			38.240012 °	38.240012 °
				-121.522418 °	-121.522418 °
DWR ID	DWR_RD0003_02_f_2018_201				
Comment Code					
TR : Tree or limb					
Inspector Comment					
Remove fallen tree limbs from the waterside slope.					

Photo 1 of 1 : FA_2021_RD0003_25_201_20210830_00112.jpg



View of fallen tree that has been chopped up on the waterside slope (October 2018).

LM Start	11.37	Rating **	U	Issue No.	168	
LM End	11.37	Issue Type +	Ma	Location *	WS	
Category	Earthen Levee			GPS Latitude/Longitude		
				Start		End
Item	Erosion / Bank Caving			38.240140 °		38.240140 °
				-121.520310 °		-121.520310 °
DWR ID	DWR_RD0003_02_s_2020_168					
Comment Code						
E2 : Schedule repair of erosion site prior to the next inspection.						
Inspector Comment						
Significant erosion into waterside slope.						

Photo 1 of 1 : FA_2021_RD0003_25_168_20210830_00094.jpg



View of erosion into the waterside slope (Spring 2020).

LM Start	11.43	Rating **	M	Issue No.	162
LM End	11.43	Issue Type +	Ma	Location *	LS
Category	Earthen Levee			GPS Latitude/Longitude	
				Start	End
Item	Encroachments			38.240198 °	38.240198 °
				-121.519290 °	-121.519290 °
DWR ID	DWR_RD0003_02_s_2019_162				
Comment Code					
TR : Tree or limb					
Inspector Comment					
Remove tree limbs from the landside slope.					

Photo 1 of 1 : FA_2021_RD0003_25_162_20210830_00089.jpg



View looking downslope at fallen tree limbs on the landside slope (Spring 2019).

* Location
LS : Land Side N/A : Not Applicable
WS : Water Side
CR : Crown

** Rating
A : Acceptable N : Not Inspected/Rated
M : Minimally Acceptable C : Corrected
U : Unacceptable A/W : Acceptable but Monitor & Maintain

+ Issue Type
Ma : Maintenance Deficiency
Ob : Design & System Obsolescence
En : Enforcement

**Flood Control Project Maintenance
Levee Inspections**

Maintenance Issue Types Only, Levee Inspection Report By Mile - Fall 2021

Reclamation District No. 0003 Grand Island

Waterway	Bank	Unit Miles	Inspection Start/End	Inspector
Unit No. 02 Right Bank Sacramento River	Right	17.35	10/05/2021 10/06/2021	David Julian

LM Start	11.51	Rating **	U	Issue No.	116	
LM End	11.51	Issue Type +	Ma	Location *	LS	
Category	Earthen Levee			GPS Latitude/Longitude		
				Start		End
Item	Trim / Thin Trees			38.240787 °		38.240787 °
				-121.517902 °		-121.517902 °
DWR ID	DWR_RD0003_02_f_2020_116					
Comment Code						
T2 : Thin trees to allow visibility of the ground and room to flood fight.						
Inspector Comment						
Trim the fig tree on the landside.						

Photo 1 of 1 : FA_2021_RD0003_25_116_20210830_00055.jpg



View of thick fig tree on the landside slope (Fall 2020).

LM Start	11.60	Rating **	M	Issue No.	202	
LM End	11.60	Issue Type +	Ma	Location *	WS	
Category	Earthen Levee			GPS Latitude/Longitude		
				Start	End	
Item	Vegetation			38.241630 °	38.241630 °	
				-121.516703 °	-121.516703 °	
DWR ID	DWR_RD0003_02_f_2019_202					
Comment Code						
V2 : Remove the wild growth other than native grasses from the levee slopes.						
Inspector Comment						
Century plants are on the waterside.						

No Photos

LM Start	12.88	Rating **	N	Issue No.	135
LM End	12.88	Issue Type +	Ma	Location *	LS
Category	Earthen Levee			GPS Latitude/Longitude	
				Start	End
Item	Trim / Thin Trees			38.257244 °	38.257244 °
				-121.518037 °	-121.518037 °
DWR ID	DWR_RD0003_02_s_2018_135				
Comment Code					
T5 : Tree stumps.					
Inspector Comment					
There is a tree stump at levee toe.					

Photo 1 of 1 : FA_2021_RD0003_25_135_20210830_00068.jpg



View looking downslope at tree trunk at the bottom of the landside slope (Spring 2019).

* Location LS : Land Side N/A : Not Applicable WS : Water Side CR : Crown		** Rating A : Acceptable M : Minimally Acceptable U : Unacceptable		N : Not Inspected/Rated C : Corrected A/W : Acceptable but Monitor & Maintain		+ Issue Type Ma : Maintenance Deficiency Ob : Design & System Obsolescence En : Enforcement	
--	--	--	--	---	--	---	--

**Flood Control Project Maintenance
Levee Inspections**

Maintenance Issue Types Only, Levee Inspection Report By Mile - Fall 2021

Reclamation District No. 0003 Grand Island

Waterway	Bank	Unit Miles	Inspection Start/End	Inspector
Unit No. 02 Right Bank Sacramento River	Right	17.35	10/05/2021 10/06/2021	David Julian

LM Start	12.92	Rating **	M	Issue No.	109
LM End	12.92	Issue Type +	Ma	Location *	LS
Category	Earthen Levee			GPS Latitude/Longitude	
				Start	End
Item	Encroachments			38.257542 °	38.257542 °
				-121.518520 °	-121.518520 °
DWR ID	DWR_RD0003_02_f_2020_109				
Comment Code					
TR : Tree or limb					
Inspector Comment					
Remove down tree limbs on the landside toe.					

No Photos

LM Start	13.10	Rating **	M	Issue No.	189	
LM End	13.10	Issue Type +	Ma	Location *	LS	
Category	Earthen Levee			GPS Latitude/Longitude		
				Start	End	
Item	Encroachments			38.259363 °	38.259363 °	
				-121.521007 °	-121.521007 °	
DWR ID	DWR_RD0003_02_f_2021_189					
Comment Code						
TR : Tree or limb						
Inspector Comment						
Remove down tree limb at landside toe.						

No Photos

* Location LS : Land Side N/A : Not Applicable WS : Water Side CR : Crown	** Rating A : Acceptable M : Minimally Acceptable U : Unacceptable	N : Not Inspected/Rated C : Corrected A/W : Acceptable but Monitor & Maintain	+ Issue Type Ma : Maintenance Deficiency Ob : Design & System Obsolescence En : Enforcement
--	--	---	---

**Flood Control Project Maintenance
Levee Inspections**

Maintenance Issue Types Only, Levee Inspection Report By Mile - Fall 2021

Reclamation District No. 0003 Grand Island

Waterway	Bank	Unit Miles	Inspection Start/End	Inspector
Unit No. 02 Right Bank Sacramento River	Right	17.35	10/05/2021 10/06/2021	David Julian

LM Start	13.15	Rating **	M	Issue No.	139
LM End	13.17	Issue Type +	Ma	Location *	WS
Category	Earthen Levee			GPS Latitude/Longitude	
				Start	End
Item	Erosion / Bank Caving			38.260042 °	38.260219 °
				-121.521581 °	-121.521803 °
DWR ID	LMA-107				
Comment Code					
E2 : Schedule repair of erosion site prior to the next inspection.					
Inspector Comment					
This was a 2017 Storm Damage site. Approximately 89 linear feet of erosion and sloughing. The erosion commences approximately 1/2 of the way down the slope from the crown and extends into the rip rap. Site ID No:281 Site Designation:LMA-107 4/8/2020 Field Notes: Evidence of minor sloughing.					

Photo 1 of 1 : FA_2021_RD0003_25_139_20210830_00072.jpg



LM Start	13.16	Rating **	M	Issue No.	108
LM End	13.16	Issue Type +	Ma	Location *	LS
Category	Earthen Levee			GPS Latitude/Longitude	
				Start	End
Item	Encroachments			38.259958 °	38.259958 °
				-121.521750 °	-121.521750 °
DWR ID	DWR_RD0003_02_f_2020_108				
Comment Code					
TR : Tree or limb					
Inspector Comment					

No Photos

* Location LS : Land Side N/A : Not Applicable WS : Water Side CR : Crown		** Rating A : Acceptable N : Not Inspected/Rated M : Minimally Acceptable C : Corrected U : Unacceptable A/W : Acceptable but Monitor & Maintain		+ Issue Type Ma : Maintenance Deficiency Ob : Design & System Obsolescence En : Enforcement
--	--	---	--	---

**Flood Control Project Maintenance
Levee Inspections**

Maintenance Issue Types Only, Levee Inspection Report By Mile - Fall 2021

Reclamation District No. 0003 Grand Island

Waterway	Bank	Unit Miles	Inspection Start/End	Inspector
Unit No. 02 Right Bank Sacramento River	Right	17.35	10/05/2021 10/06/2021	David Julian

LM Start	13.30	Rating **	M	Issue No.	124
LM End	13.30	Issue Type +	Ma	Location *	LS
Category	Earthen Levee			GPS Latitude/Longitude	
				Start	End
Item	Encroachments			38.261435 °	38.261435 °
				-121.523613 °	-121.523613 °
DWR ID	DWR_RD0003_02_s_2021_124				
Comment Code					
TR : Tree or limb					
Inspector Comment					

Photo 1 of 1 : FA_2021_RD0003_25_124_20210830_00061.jpg



View of down tree limbs on the landside slope (Spring 2021).

LM Start	13.32	Rating **	C	Issue No.	107
LM End	13.32	Issue Type +	Ma	Location *	LS
Category	Earthen Levee			GPS Latitude/Longitude	
				Start	End
Item	Trim / Thin Trees			38.261645 °	38.261645 °
				-121.523828 °	-121.523828 °
DWR ID	DWR_RD0003_02_f_2020_107				
Comment Code					
T2 : Thin trees to allow visibility of the ground and room to flood fight.					
Inspector Comment					

No Photos

LM Start	14.86	Rating **	M	Issue No.	188
LM End	14.95	Issue Type +	Ma	Location *	LS
Category	Earthen Levee			GPS Latitude/Longitude	
				Start	End
Item	Vegetation			38.277098 °	38.278156 °
				-121.544184 °	-121.545363 °
DWR ID	DWR_RD0003_02_f_2021_188				
Comment Code					
V1 : Control annual grass and weeds on the levee slopes and easements.					
Inspector Comment					

No Photos

* Location		** Rating		+ Issue Type	
LS : Land Side	N/A : Not Applicable	A : Acceptable	N : Not Inspected/Rated	Ma : Maintenance Deficiency	
WS : Water Side		M : Minimally Acceptable	C : Corrected	Ob : Design & System Obsolescence	
CR : Crown		U : Unacceptable	A/W : Acceptable but Monitor & Maintain	En : Enforcement	

**Flood Control Project Maintenance
Levee Inspections**

Maintenance Issue Types Only, Levee Inspection Report By Mile - Fall 2021

Reclamation District No. 0003 Grand Island

Waterway	Bank	Unit Miles	Inspection Start/End	Inspector
Unit No. 02 Right Bank Sacramento River	Right	17.35	10/05/2021 10/06/2021	David Julian

LM Start	15.04	Rating **	U	Issue No.	142
LM End	15.04	Issue Type +	Ma	Location *	WS
Category	Earthen Levee			GPS Latitude/Longitude	
				Start	End
Item	Erosion / Bank Caving			38.279083 °	38.279083 °
				-121.546406 °	-121.546406 °
DWR ID	LMA-108				
Comment Code					
E2 : Schedule repair of erosion site prior to the next inspection.					
Inspector Comment					
This was a 2017 Storm Damage site. Approximately 330 linear feet of erosion and sloughing. The erosion commences approximately 1/2 of the way down the slope from the crown and extends into the rip rap. Site ID No:282 Site Designation:LMA-108 4/8/2020 Field Notes: Significant erosion into waterside toe.					

Photo 1 of 1 : FA_2021_RD0003_25_142_20210830_00074.jpg



View erosion into the waterside slope (Spring 2020).

LM Start	15.16	Rating **	M	Issue No.	187
LM End	15.16	Issue Type +	Ma	Location *	LS
Category	Earthen Levee			GPS Latitude/Longitude	
				Start	End
Item	Encroachments			38.280239 °	38.280239 °
				-121.547971 °	-121.547971 °
DWR ID	DWR_RD0003_02_f_2021_187				
Comment Code					
TR : Tree or limb					
Inspector Comment					

No Photos

* Location LS : Land Side N/A : Not Applicable WS : Water Side CR : Crown	** Rating A : Acceptable M : Minimally Acceptable U : Unacceptable	N : Not Inspected/Rated C : Corrected A/W : Acceptable but Monitor & Maintain	+ Issue Type Ma : Maintenance Deficiency Ob : Design & System Obsolescence En : Enforcement
--	--	---	---

**Flood Control Project Maintenance
Levee Inspections**

Maintenance Issue Types Only, Levee Inspection Report By Mile - Fall 2021

Reclamation District No. 0003 Grand Island

Waterway	Bank	Unit Miles	Inspection Start/End	Inspector
Unit No. 02 Right Bank Sacramento River	Right	17.35	10/05/2021 10/06/2021	David Julian

LM Start	15.21	Rating **	M	Issue No.	190
LM End	15.21	Issue Type +	Ma	Location *	LS
Category	Earthen Levee			GPS Latitude/Longitude	
				Start	End
Item	Encroachments			38.280765 °	38.280765 °
				-121.548640 °	-121.548640 °
DWR ID	DWR_RD0003_02_f_2019_190				
Comment Code					
TR : Tree or limb					
Inspector Comment					

No Photos

LM Start	15.22	Rating **	U	Issue No.	177
LM End	15.22	Issue Type +	Ma	Location *	LS
Category	Earthen Levee			GPS Latitude/Longitude	
				Start	End
Item	Animal Control			38.280861 °	38.280861 °
				-121.548791 °	-121.548791 °
DWR ID	DWR_RD0003_02_f_2021_177				
Comment Code					
A1 : Exterminate rodents and backfill and compact or grout burrows.					
Inspector Comment					
Multiple fresh rodent holes. LMA is baiting.					

Photo 1 of 1 : FA_2021_RD0003_25_177_20211014_00295.jpg

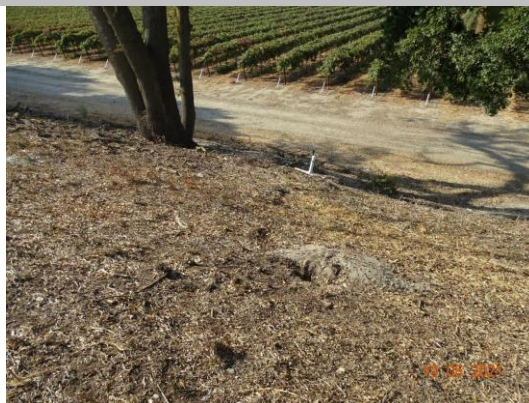

View looking downslope at fresh rodent holes and rodent bait station in the landside slope (Fall 2021).

LM Start	15.41	Rating **	M	Issue No.	151
LM End	15.43	Issue Type +	Ma	Location *	LS
Category	Earthen Levee			GPS Latitude/Longitude	
				Start	End
Item	Animal Control			38.282541 °	38.282703 °
				-121.551577 °	-121.551863 °
DWR ID	DWR_RD0003_02_f_2021_151				
Comment Code					
A1 : Exterminate rodents and backfill and compact or grout burrows.					
Inspector Comment					
Multiple fresh rodent holes.					

Photo 1 of 1 : FA_2021_RD0003_25_151_20211014_00294.jpg



View looking downslope at fresh rodent holes in the landside slope (Fall 2021).

* Location
LS : Land Side N/A : Not Applicable
WS : Water Side
CR : Crown

** Rating
A : Acceptable N : Not Inspected/Rated
M : Minimally Acceptable C : Corrected
U : Unacceptable A/W : Acceptable but Monitor & Maintain

+ Issue Type
Ma : Maintenance Deficiency
Ob : Design & System Obsolescence
En : Enforcement

**Flood Control Project Maintenance
Levee Inspections**

Maintenance Issue Types Only, Levee Inspection Report By Mile - Fall 2021

Reclamation District No. 0003 Grand Island

Waterway	Bank	Unit Miles	Inspection Start/End	Inspector
Unit No. 02 Right Bank Sacramento River	Right	17.35	10/05/2021 10/06/2021	David Julian

LM Start	15.43	Rating **	N	Issue No.	122
LM End	15.43	Issue Type +	Ma	Location *	LS
Category	Earthen Levee			GPS Latitude/Longitude	
				Start	End
Item	Trim / Thin Trees			38.282672 °	38.282672 °
				-121.551847 °	-121.551847 °
DWR ID	DWR_RD0003_02_f_2018_122				
Comment Code					
T5 : Tree stumps.					
Inspector Comment					
Remove tree stump from the landside toe.					

Photo 1 of 1 : FA_2021_RD0003_25_122_20210830_00060.jpg



View of large stump at the landside toe of the levee (October 2018).

LM Start	15.46	Rating **	A/W	Issue No.	149
LM End	15.47	Issue Type +	Ma	Location *	WS
Category	Earthen Levee			GPS Latitude/Longitude	
				Start	End
Item	Erosion / Bank Caving			38.283119 °	38.283172 °
				-121.552250 °	-121.552347 °
DWR ID	LMA-109				
Comment Code					
E1 : Note and monitor erosion site.					
Inspector Comment					
This was a 2017 Storm Damage site. Approximately 33 linear feet of erosion. The erosion commences approximately 1/2 of the way down the slope from the crown and extends into the rip rap. A section of rip rap has eroded away in this location. Site ID No:283 Site Designation:LMA-109 4/8/2020 Field Notes: Very minor erosion into waterside toe. Monitor.					

Photo 1 of 1 : FA_2021_RD0003_25_149_20210830_00079.jpg



* Location LS : Land Side N/A : Not Applicable WS : Water Side CR : Crown		** Rating A : Acceptable M : Minimally Acceptable U : Unacceptable N : Not Inspected/Rated C : Corrected A/W : Acceptable but Monitor & Maintain		+ Issue Type Ma : Maintenance Deficiency Ob : Design & System Obsolescence En : Enforcement	
---	--	--	--	--	--

**Flood Control Project Maintenance
Levee Inspections**

Maintenance Issue Types Only, Levee Inspection Report By Mile - Fall 2021

Reclamation District No. 0003 Grand Island

Waterway	Bank	Unit Miles	Inspection Start/End	Inspector
Unit No. 02 Right Bank Sacramento River	Right	17.35	10/05/2021 10/06/2021	David Julian

LM Start	15.77	Rating **	U	Issue No.	144
LM End	15.77	Issue Type +	Ma	Location *	LS
Category	Earthen Levee			GPS Latitude/Longitude	
				Start	End
Item	Animal Control			38.286076 °	38.286076 °
				-121.556415 °	-121.556415 °
DWR ID	DWR_RD0003_02_f_2021_144				
Comment Code					
A1 : Exterminate rodents and backfill and compact or grout burrows.					
Inspector Comment					
A couple large fresh rodent holes.					

Photo 1 of 1 : FA_2021_RD0003_25_144_20211014_00293.jpg



View of looking downslope at fresh rodent holes in the landside slope (Fall 2021).

LM Start	15.79	Rating **	C	Issue No.	126
LM End	15.79	Issue Type +	Ma	Location *	LS
Category	Earthen Levee			GPS Latitude/Longitude	
				Start	End
Item	Encroachments			38.286352 °	38.286352 °
				-121.556683 °	-121.556683 °
DWR ID	DWR_RD0003_02_s_2021_126				
Comment Code					
PR : Prunings					
Inspector Comment					

No Photos

LM Start	15.81	Rating **	M	Issue No.	143
LM End	15.81	Issue Type +	Ma	Location *	LS
Category	Earthen Levee			GPS Latitude/Longitude	
				Start	End
Item	Slope Stability			38.286578 °	38.286578 °
				-121.556951 °	-121.556951 °
DWR ID	DWR_RD0003_02_f_2021_143				
Comment Code					
S1 : Repair slope instability.					
Inspector Comment					
Depression at the top of the landside slope.					

Photo 1 of 1 : FA_2021_RD0003_25_143_20211014_00292.jpg



View looking downslope at depression in the landside slope (Fall 2021).

* Location LS : Land Side N/A : Not Applicable WS : Water Side CR : Crown		** Rating A : Acceptable M : Minimally Acceptable U : Unacceptable		N : Not Inspected/Rated C : Corrected A/W : Acceptable but Monitor & Maintain		+ Issue Type Ma : Maintenance Deficiency Ob : Design & System Obsolescence En : Enforcement	
--	--	--	--	---	--	---	--

**Flood Control Project Maintenance
Levee Inspections**

Maintenance Issue Types Only, Levee Inspection Report By Mile - Fall 2021

Reclamation District No. 0003 Grand Island

Waterway	Bank	Unit Miles	Inspection Start/End	Inspector
Unit No. 02 Right Bank Sacramento River	Right	17.35	10/05/2021 10/06/2021	David Julian

LM Start	15.81	Rating **	M	Issue No.	133
LM End	15.81	Issue Type +	Ma	Location *	LS
Category	Earthen Levee			GPS Latitude/Longitude	
				Start	End
Item	Animal Control			38.286577 °	38.286577 °
				-121.556954 °	-121.556954 °
DWR ID	DWR_RD0003_02_f_2021_133				
Comment Code					
A1 : Exterminate rodents and backfill and compact or grout burrows.					
Inspector Comment					
A couple fresh rodent holes. LMA is baiting.					

Photo 1 of 1 : FA_2021_RD0003_25_133_20211014_00291.jpg



View looking downstream at rodent bait station on the landside slope (Fall 2021).

LM Start	15.86	Rating **	M	Issue No.	104
LM End	15.86	Issue Type +	Ma	Location *	LS
Category	Earthen Levee			GPS Latitude/Longitude	
				Start	End
Item	Animal Control			38.287104 °	38.287104 °
				-121.557485 °	-121.557485 °
DWR ID	DWR_RD0003_02_f_2021_104				
Comment Code					
A1 : Exterminate rodents and backfill and compact or grout burrows.					
Inspector Comment					
Fresh animal hole. LMA is baiting.					

Photo 1 of 1 : FA_2021_RD0003_25_104_20211014_00290.jpg



View looking downstream at fresh rodent hole and bait station on the landside slope (Fall 2021).

* Location
LS : Land Side N/A : Not Applicable
WS : Water Side
CR : Crown

** Rating
A : Acceptable N : Not Inspected/Rated
M : Minimally Acceptable C : Corrected
U : Unacceptable A/W : Acceptable but Monitor & Maintain

+ Issue Type
Ma : Maintenance Deficiency
Ob : Design & System Obsolescence
En : Enforcement

**Flood Control Project Maintenance
Levee Inspections**

Maintenance Issue Types Only, Levee Inspection Report By Mile - Fall 2021

Reclamation District No. 0003 Grand Island

Waterway	Bank	Unit Miles	Inspection Start/End	Inspector
Unit No. 02 Right Bank Sacramento River	Right	17.35	10/05/2021 10/06/2021	David Julian

LM Start	15.99	Rating **	A/W	Issue No.	106
LM End	15.99	Issue Type +	Ma	Location *	LS
Category	Earthen Levee			GPS Latitude/Longitude	
				Start	End
Item	Animal Control			38.288582 °	38.288582 °
				-121.558950 °	-121.558950 °
DWR ID	DWR_RD0003_02_f_2020_106				
Comment Code					
A1 : Exterminate rodents and backfill and compact or grout burrows.					
Inspector Comment					
Animal holes have been covered over. Monitor.					

Photo 1 of 1 : FA_2021_RD0003_25_106_20210830_00048.jpg



View looking downstream at animal holes on the landside shoulder and slope (Fall 2020).

LM Start	16.07	Rating **	A/W	Issue No.	119
LM End	16.07	Issue Type +	Ma	Location *	LS
Category	Earthen Levee			GPS Latitude/Longitude	
				Start	End
Item	Animal Control			38.289377 °	38.289377 °
				-121.560002 °	-121.560002 °
DWR ID	DWR_RD0003_02_f_2019_119				
Comment Code					
A1 : Exterminate rodents and backfill and compact or grout burrows.					
Inspector Comment					
Animal holes have been covered over. Monitor.					

Photo 1 of 1 : FA_2021_RD0003_25_119_20210830_00057.jpg



View looking downstream at fresh rodent holes in landside slope (Fall 2019).

* Location LS : Land Side N/A : Not Applicable WS : Water Side CR : Crown		** Rating A : Acceptable N : Not Inspected/Rated M : Minimally Acceptable C : Corrected U : Unacceptable A/W : Acceptable but Monitor & Maintain		+ Issue Type Ma : Maintenance Deficiency Ob : Design & System Obsolescence En : Enforcement
--	--	---	--	---

**Flood Control Project Maintenance
Levee Inspections**

Maintenance Issue Types Only, Levee Inspection Report By Mile - Fall 2021

Reclamation District No. 0003 Grand Island

Waterway	Bank	Unit Miles	Inspection Start/End	Inspector
Unit No. 02 Right Bank Sacramento River	Right	17.35	10/05/2021 10/06/2021	David Julian

LM Start	16.27	Rating **	M	Issue No.	115
LM End	16.27	Issue Type +	Ma	Location *	LS
Category	Earthen Levee			GPS Latitude/Longitude	
				Start	End
Item	Slope Stability			38.291552 °	38.291552 °
				-121.562552 °	-121.562552 °
DWR ID	DWR_RD0003_02_f_2019_115				
Comment Code					
S2 : Repair the levee slope damaged by foot traffic and prevent access where possible.					
Inspector Comment					

Photo 1 of 1 : FA_2021_RD0003_25_115_20210830_00054.jpg



View of depression in the landside slope. Might be due to drainage (Fall 2019).

LM Start	16.33	Rating **	M	Issue No.	103	
LM End	16.33	Issue Type +	Ma	Location *	LS	
Category	Earthen Levee			GPS Latitude/Longitude		
				Start		End
Item	Encroachments			38.292250 °		38.292250 °
				-121.563204 °		-121.563204 °
DWR ID	DWR_RD0003_02_f_2021_103					
Comment Code						
TR : Tree or limb						
Inspector Comment						

No Photos

* Location LS : Land Side N/A : Not Applicable WS : Water Side CR : Crown		** Rating A : Acceptable N : Not Inspected/Rated M : Minimally Acceptable C : Corrected U : Unacceptable A/W : Acceptable but Monitor & Maintain		+ Issue Type Ma : Maintenance Deficiency Ob : Design & System Obsolescence En : Enforcement
--	--	---	--	---

**Flood Control Project Maintenance
Levee Inspections**

Maintenance Issue Types Only, Levee Inspection Report By Mile - Fall 2021

Reclamation District No. 0003 Grand Island

Waterway	Bank	Unit Miles	Inspection Start/End	Inspector
Unit No. 02 Right Bank Sacramento River	Right	17.35	10/05/2021 10/06/2021	David Julian

LM Start	16.54	Rating **	U	Issue No.	150
LM End	16.56	Issue Type +	Ma	Location *	WS
Category	Earthen Levee			GPS Latitude/Longitude	
				Start	End
Item	Erosion / Bank Caving			38.294717 °	38.294986 °
				-121.565417 °	-121.565661 °
DWR ID	LMA-110				
Comment Code					
E2 : Schedule repair of erosion site prior to the next inspection.					
Inspector Comment					
This was a 2017 Storm Damage site. Approximately 122 linear feet of erosion. The erosion commences approximately 1/2 of the way down the slope from the crown and extends beyond the rip rap. A section of rip rap has eroded away in this location. Site ID No:284 Site Designation:LMA-110 4/8/2020 Field Notes: Erosion into waterside slope.					

Photo 1 of 1 : FA_2021_RD0003_25_150_20210830_00080.jpg



View of erosion into the waterside slope (Spring 2020).

LM Start	16.84	Rating **	M	Issue No.	112
LM End	16.86	Issue Type +	Ma	Location *	LS
Category	Earthen Levee			GPS Latitude/Longitude	
				Start	End
Item	Animal Control			38.298165 °	38.298371 °
				-121.568842 °	-121.569008 °
DWR ID	DWR_RD0003_02_f_2019_112				
Comment Code					
A1 : Exterminate rodents and backfill and compact or grout burrows.					
Inspector Comment					
There are a couple rodent holes with fresh material.					

Photo 1 of 1 : FA_2021_RD0003_25_112_20211014_00288.jpg



View looking downslope at fresh rodent holes on the landside slope (Fall 2021).

* Location LS : Land Side N/A : Not Applicable WS : Water Side CR : Crown		** Rating A : Acceptable N : Not Inspected/Rated M : Minimally Acceptable C : Corrected U : Unacceptable A/W : Acceptable but Monitor & Maintain		+ Issue Type Ma : Maintenance Deficiency Ob : Design & System Obsolescence En : Enforcement	
---	--	--	--	--	--

**Flood Control Project Maintenance
Levee Inspections**

Maintenance Issue Types Only, Levee Inspection Report By Mile - Fall 2021

Reclamation District No. 0003 Grand Island

Waterway	Bank	Unit Miles	Inspection Start/End	Inspector
Unit No. 02 Right Bank Sacramento River	Right	17.35	10/05/2021 10/06/2021	David Julian

LM Start	16.93	Rating **	M	Issue No.	105
LM End	16.93	Issue Type +	Ma	Location *	LS
Category	Earthen Levee			GPS Latitude/Longitude	
				Start	End
Item	Encroachments			38.299233 °	38.299233 °
				-121.569667 °	-121.569667 °
DWR ID	DWR_RD0003_02_f_2020_105				
Comment Code					
TR : Tree or limb					
Inspector Comment					

Photo 1 of 1 : FA_2021_RD0003_25_105_20210830_00047.jpg



View of down tree limb on the landside slope (Fall 2020).

LM Start	17.06	Rating **	N	Issue No.	111
LM End	17.06	Issue Type +	Ma	Location *	LS
Category	Earthen Levee			GPS Latitude/Longitude	
				Start	End
Item	Trim / Thin Trees			38.300783 °	38.300783 °
				-121.570958 °	-121.570958 °
DWR ID	DWR_RD0003_02_f_2019_111				
Comment Code					
T5 : Tree stumps.					
Inspector Comment					

Photo 1 of 1 : FA_2021_RD0003_25_111_20210830_00050.jpg



View of recently cut tree stumps on the landside shoulder (Fall 2019).

LM Start	17.27	Rating **	M	Issue No.	114
LM End	17.27	Issue Type +	Ma	Location *	LS
Category	Earthen Levee			GPS Latitude/Longitude	
				Start	End
Item	Slope Stability			38.303351 °	38.303351 °
				-121.573084 °	-121.573084 °
DWR ID	DWR_RD0003_02_s_2020_114				
Comment Code					
S1 : Repair slope instability.					
Inspector Comment					
There is a depression on the landside slope.					

Photo 1 of 1 : FA_2021_RD0003_25_114_20211014_00285.jpg



View looking downstream at depression on the landside slope (Fall 2021).

* Location		** Rating		+ Issue Type	
LS : Land Side	N/A : Not Applicable	A : Acceptable	N : Not Inspected/Rated	Ma : Maintenance Deficiency	
WS : Water Side		M : Minimally Acceptable	C : Corrected	Ob : Design & System Obsolescence	
CR : Crown		U : Unacceptable	A/W : Acceptable but Monitor & Maintain	En : Enforcement	

**Flood Control Project Maintenance
Levee Inspections**

Maintenance Issue Types Only, Levee Inspection Report By Mile - Fall 2021

Reclamation District No. 0003 Grand Island

Waterway	Bank	Unit Miles	Inspection Start/End	Inspector
Unit No. 02 Right Bank Sacramento River	Right	17.35	10/05/2021 10/06/2021	David Julian

LM Start	17.29	Rating **	N	Issue No.	113
LM End	17.29	Issue Type +	Ma	Location *	LS
Category	Earthen Levee			GPS Latitude/Longitude	
				Start	End
Item	Trim / Thin Trees			38.303558 °	38.303558 °
				-121.573380 °	-121.573380 °
DWR ID	DWR_RD0003_02_s_2019_113				
Comment Code					
T5 : Tree stumps.					
Inspector Comment					
There is a tree stump about 6" at bottom of the levee slope.					

Photo 1 of 1 : FA_2021_RD0003_25_113_20210830_00052.jpg



View looking downslope at tree stumps on the landside (Spring 2019).

* Location LS : Land Side N/A : Not Applicable WS : Water Side CR : Crown	** Rating A : Acceptable M : Minimally Acceptable U : Unacceptable	N : Not Inspected/Rated C : Corrected A/W : Acceptable but Monitor & Maintain	+ Issue Type Ma : Maintenance Deficiency Ob : Design & System Obsolescence En : Enforcement
--	--	---	---

**Flood Control Project Maintenance
Levee Inspections**

Maintenance Issue Types Only, Levee Inspection Report By Mile - Fall 2021

Reclamation District No. 0003 Grand Island

Waterway	Bank	Unit Miles	Inspection Start/End	Inspector
Unit No. 03 Cross Levee		0.43	10/06/2021 10/06/2021	David Julian

LM Start	0.30	Rating **	M	Issue No.	1
LM End	0.30	Issue Type +	Ma	Location *	LS
Category	Earthen Levee			GPS Latitude/Longitude	
				Start	End
Item	Vegetation			38.177955 °	38.177955 °
				-121.653710 °	-121.653710 °
DWR ID	DWR_RD0003_03_f_2021_1				
Comment Code					
V2 : Remove the wild growth other than native grasses from the levee slopes.					
Inspector Comment					
Willows on the landside slope.					

Photo 1 of 1 : FA_2021_RD0003_610_1_20211006_00003.jpg



View of willows on the landside slope (Fall 2021).

LM Start	0.37	Rating **	M	Issue No.	5
LM End	0.37	Issue Type +	Ma	Location *	LS
Category	Earthen Levee			GPS Latitude/Longitude	
				Start	End
Item	Vegetation			38.176857 °	38.176857 °
				-121.653785 °	-121.653785 °
DWR ID	DWR_RD0003_03_s_2020_5				
Comment Code					
V2 : Remove the wild growth other than native grasses from the levee slopes.					
Inspector Comment					
Trim willows back from landside slope.					

Photo 1 of 1 : FA_2021_RD0003_610_5_20210830_00001.jpg



View of willows on the landside slope (Spring 2021).

* Location LS : Land Side N/A : Not Applicable WS : Water Side CR : Crown		** Rating A : Acceptable N : Not Inspected/Rated M : Minimally Acceptable C : Corrected U : Unacceptable A/W : Acceptable but Monitor & Maintain		+ Issue Type Ma : Maintenance Deficiency Ob : Design & System Obsolescence En : Enforcement
--	--	---	--	---